

RETURN TO: DANIELS LAND SURVEYING, 22598 18TH AVENUE, NEW VIRGINIA IA 50210 (515) 577-2583

**UNITED STATES PUBLIC LAND CORNER CERTIFICATE**

Land Survey Monuments in Section 11, Township 74 North, Range 26 West of the 5th P.M., Madison County, Iowa.  
 Previously recorded in n.a. in the County Recorder's Office

**MONUMENT DESCRIPTIONS AND REMARKS:**

SW COR. NW 1/4 SE 1/4 - Set midpoint and online between Center and S 1/4 Corner.  
 SE COR. NW 1/4 SE 1/4 - Set at mathematical Center of SE 1/4 using all recorded monuments in the SE 1/4.  
 Both monuments are 1/2" x 20" red plastic cap rebar, #17532

**PLAN VIEW**

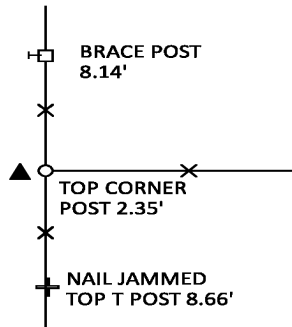
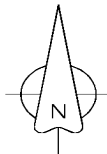

SW COR. NW 1/4 SE 1/4

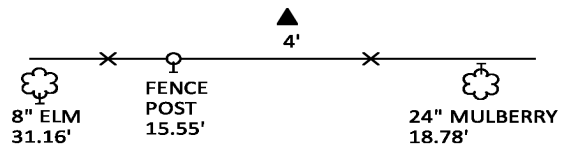

SE COR. NW 1/4 SE 1/4

ALL TIES TO 40d RING SHANK NAILS UNLESS NOTED

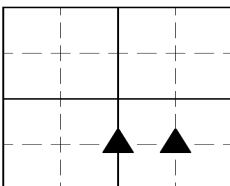

Section Number:

**11**

Project Number: 1633

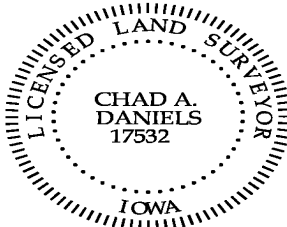

I hereby certify that this surveying document was prepared by me and the related survey work was performed by me or under my direct personal supervision and that I am a duly licensed Land Surveyor under the laws of the State of Iowa.

Signed Chad A. Daniels 6/2/21  
 Chad A. Daniels Date

Iowa License No. 17532  
 My license renewal date is 12-31-2022