



Book 2025 Page 2253

Document 2025 GWH-2253 Type 53 001 Pages 9
Date 8/21/2025 Time 3:37:20PM
Rec Amt \$.00

Daneen Schindler, RECORDER/REGISTRAR
DELAWARE COUNTY IOWA

REAL ESTATE TRANSFER - GROUNDWATER HAZARD STATEMENT
TO BE COMPLETED BY TRANSFEROR

If the transaction is exempt from filing a declaration of value pursuant to Iowa Code 428A.1(2), **STOP HERE**. Pursuant to Iowa Code section 558.69(1), when no declaration of value is submitted during a transaction, you are not required to submit a groundwater hazard statement or include the statutory language in Iowa Code section 558.69(8A). Please consult your realtor or legal counsel for further advice, including on whether a declaration of value is required. The Department provides this information for statutory reference only.

Instructions for this document can be found at:

<https://www.iowadnr.gov/Portals/idnr/uploads/forms/5420960%20Instructions.pdf>

Attachment 1, if required, can be found at: <https://www.iowadnr.gov/Portals/idnr/uploads/forms/5420960a.pdf>

TRANSFEROR:

Name: Joyce Marie Wellman, aka Joyce W. Kessenich, aka Joyce Kessenich
Address: 26236 213th Avenue, Delhi, IA 52223

TRANSFeree:

Name: Next Level 15 Properties, LLC
Address: c/o David Wright, 3100 N Center Point Rd, Cedar Rapids, IA 52411

Address of Property Transferred:

26236 and 26238 213th Avenue, Delhi, Iowa 52223

Legal Description of Property: (Attach if necessary)

Lots Eighteen (18) and Nineteen (19) of Wellman's Seven Coves A Subdivision of a Parcel in the NE¼ of the NW¼ Section 25, T 88 N, R 5 W of the 5th P.M. Delaware County, Iowa, according to plat recorded in Book 6 Plats, Page 30; also all lake frontage as pertaining to said Lots Eighteen (18) and Nineteen (19) running to the waterfront and then at right angles to the middle of Delhi Lake; also Parcel 2021-82 Part of Lot 17 of Wellman's Seven Coves Subdivision In Section Twenty-Five (25), Township Eighty-Eight North (T88N), Range Five West (R5W) of the Fifth Principal Meridian, Delaware County, Iowa, according to plat recorded in Book 2021, Page 2185; also all lake frontage pertaining to said Parcel 2021-82 running to the waterfront and then at right angles to the middle of Delhi Lake

AND

Lots Twenty (20) and Twenty One (21) of Wellman's Seven Coves 2nd Subdivision Delaware County, Iowa, according to plat recorded in Book 2008, Page 3417; also Parcel 2021-80 Part of Lot 22 of Wellman's Seven Coves 2nd Subdivision in Section Twenty-Five (25), Township Eighty-Eight (T88N), Range Five West (R5W) of the Fifth Principal Meridian, Delaware County, Iowa, according to plat recorded in Book 2021, Page 2185

1. Wells (check one)

- ☐ No Condition - There are no known wells situated on this property.
- ☒ Condition Present - There is a well or wells situated on this property. The type(s), location(s) and legal status are stated below or set forth on an attached separate sheet, as necessary.

2. Solid Waste Disposal (check one)

- ☒ No Condition - There is no known solid waste disposal site on this property.
- ☐ Condition Present - There is a solid waste disposal site on this property and information related thereto is provided in Attachment #1, attached to this document.

3. Hazardous Wastes (check one)

- ☒ No Condition - There is no known hazardous waste on this property.
- ☐ Condition Present - There is hazardous waste on this property and information related thereto is provided in Attachment #1, attached to this document.

4. Underground Storage Tanks (check one)

- ☒ No Condition - There are no known underground storage tanks on this property. (Note exclusions such as small farm and residential motor fuel tanks, most heating oil tanks, cisterns and septic tanks, in instructions.)
- ☐ Condition Present - There is an underground storage tank on this property. The type(s), size(s) and any known substance(s) contained are listed below or on an attached separate sheet, as necessary.

5. Private Burial Site (check one)

- ☒ No Condition - There are no known private burial sites on this property.
- ☐ Condition Present - There is a private burial site on this property. The location(s) of the site(s) and known identifying information of the decedent(s) is stated below or on an attached separate sheet, as necessary.

6. Private Sewage Disposal System (check one)

- ☐ No Condition - All buildings on this property are served by a public or semi-public sewage disposal system.
- ☐ No Condition - This transaction does not involve the transfer of any building which has or is required by law to have a sewage disposal system.
- ☒ Condition Present - There is a building served by private sewage disposal system on this property or a building without any lawful sewage disposal system. A certified inspector's report is attached which documents the condition of the private sewage disposal system and whether any modifications are required to conform to standards adopted by the Department of Natural Resources. A certified inspection report must be accompanied by this form when recording.
- ☐ Condition Present - There is a building served by private sewage disposal system on this property. Weather or other temporary physical conditions prevent the certified inspection of the private sewage disposal system from being conducted. The buyer has executed a binding acknowledgment with the county board of health to conduct a certified inspection of the private sewage disposal system at the earliest practicable time and to be responsible for any required modifications to the private sewage disposal system as identified by the certified inspection. A copy of the binding acknowledgment is attached to this form.
- ☐ Condition Present - There is a building served by private sewage disposal system on this property. The system is failing to ensure effective wastewater treatment or is otherwise improperly functioning, and the buyer has executed a binding acknowledgment with the county board of health to install a new private sewage disposal system on this property within an agreed upon time period. A copy of the binding acknowledgment is provided with this form.
- ☐ Condition Present - There is a building served by private sewage disposal system on this property. The building to which the sewage disposal system is connected will be demolished without being occupied. The buyer has executed a binding acknowledgment with the county board of health to demolish the building within an agreed upon time period. A copy of the binding acknowledgment is provided with this form. [Exemption #7]
- ☐ Condition Present - There is a building served by private sewage disposal system on this property. This property is exempt from the private sewage disposal inspection requirements pursuant to the following Exemption [Note: for exemption #7 use prior check box]:
_____.

- ☐ Condition Present - There is a building served by private sewage disposal system on this property. The private sewage disposal system has been installed within the past two years pursuant to permit number:

Review the following two directions carefully:

- A. If you selected a box stating "No Condition" for every numbered section above, **STOP HERE. Do not submit this form.** Instead, pursuant to Iowa Code section 558.69(8A), you must include the following language on the first page of the recorded deed, instrument, or other writing:

"There is no known private burial site, well, solid waste disposal site, underground storage tank, hazardous waste, or private sewage disposal system on the property as described in Iowa Code section 558.69, and therefore the transaction is exempt from the requirement to submit a groundwater hazard statement."

Please consult your realtor or legal counsel for further advice on this exemption. By law, the owner of the property is responsible for the accuracy of this statement, and the Department provides this information for statutory reference only.

- B. If you checked any box stating "Condition Present" for any of the numbered sections above, **continue below.** You must complete this form, including providing all required information, and you must submit this form to the county recorder's office with declaration of value.

Information required by statements checked above should be provided here or on separate sheets attached hereto:

Near the south fence line, west of Carriage House,

I HEREBY DECLARE THAT I HAVE REVIEWED THE INSTRUCTIONS FOR THIS FORM AND THAT THE INFORMATION STATED ABOVE IS TRUE AND CORRECT.

Signature: Joyce M. Wellman Telephone No.: (563) 608-1711
(Transferor)



IOWA DEPARTMENT OF NATURAL RESOURCES

GOVERNOR KIM REYNOLDS
LT. GOVERNOR CHRIS COURNOYER

DIRECTOR KAYLA LYON

TIME OF TRANSFER INSPECTION TOT# 17142 BILL DOWNS CERT # 8880

Site Information

Parcel Description: **Joyce Wellman**

Address: **26236 213th Ave, Delhi, IA 52223**

County: **Delaware**

Owner Information

Property is owned by a business: **No**

Business Name:

Owner Name: **Joyce Wellman**

Email Address:

Address: **26236 213th Ave, Delhi, IA 52223**

Phone No: **563-608-1711**

Additional Contact Information

Name

Mary Kay Stark

Email Address

marykaystarks@gmail.com

Affiliate Type

Realtor

Site related information

No Of Bedrooms: **5**

Facility Type: **Residential**

Last Occupied:

Permit issued by County: **Yes**

All plumbing fixtures enter septic system: **Yes**

Property Information Comments:

Inspection Date: **08/20/2025**

Currently Occupied: **Yes**

System Installation Date: **04/03/2006**

Permit Number: **1412**

County contacted for records: **Yes**

Primary Treatment

Tank 1

Tank Name: **Tank 1**

Tank Material: **Concrete**

No. of Compartments: **2**

Type: **Septic Tank**

Tank Corrosion Type: **None**

Pump Tank Chamber: **Yes**

Tank Size (Gal): **1500**

Liquid Level Type: **Normal**

Licensed Pumper Name: **Bill Downs**

Date Pumped: **8/20/2025**

Meets Setback to Well: **Yes**

Well Type: **Private**

Distance To Well (Ft.): **78**

Is Accessible: **Yes**

Lid Intact: **Yes**

Risers Intact: **Yes**

Effluent Filter Present: **No**

Watertight: **Yes**

Tank/Vault Pumped: **Yes**

Inlet Baffle Present: **Yes**

Outlet Baffle Present: **Yes**

Functioning as Designed: **Yes**

Tank Comments:

General Primary Treatment Comments:

Distribution Type

Distribution Box 1

Label: **Distribution Box 1**

Material Type: **Plastic**

Accessible: **Yes**

Box Opened: **Yes**

Baffle Present: **Yes**

Speed Levelers Present: **No**

Watertight: **Yes**

Functioning As Designed: **Yes**

General Distribution System Comments : **House has 2 bedrooms, garage (B&B) has 2 bedrooms
100+ from the lake**

Secondary Treatment

Absorption Bed1

Distribution Type: **Distribution Box**

Material Type: **Rock and PVC Pipe**

Absorption Bed Width: **15**

Absorption Bed Length: **60**

Total Absorption Area: **900**

System Hydraulic Loaded: **Yes**

Gallons Loaded: **400**

Meets Setback to Well: **Yes**

Well Type: **Private**

Distance To Well (Ft.): **78**

Absorption Bed Probed: **Yes**

Saturation or Ponding Present: **No**

Grass Cover Present: **Yes**

System Located on Owner Property: **Yes**

Easement Present: **N/A**

Functioning as Designed: **Yes**

Comments: **4 lines used in D box**

General Secondary Treatment Comments:

Narrative Report

TOT Inspection Report Overall Narrative Comments: **Everything working well at time of inspection.**

TIME OF TRANSFER INSPECTION TOT# 17142 BILL DOWNS CERT # 8880

Owner Name: **Joyce Wellman**

Address: **26236 213th Ave , Delhi , IA 52223**

County: **Delaware**

Inspection Date: **08/20/2025**

Submitted Date: **8/21/2025**

This page certifies a Time of Transfer inspection was conducted and submitted for the property listed above in accordance with Subrule 567 IAC 69.2(8).

As-built Diagrams

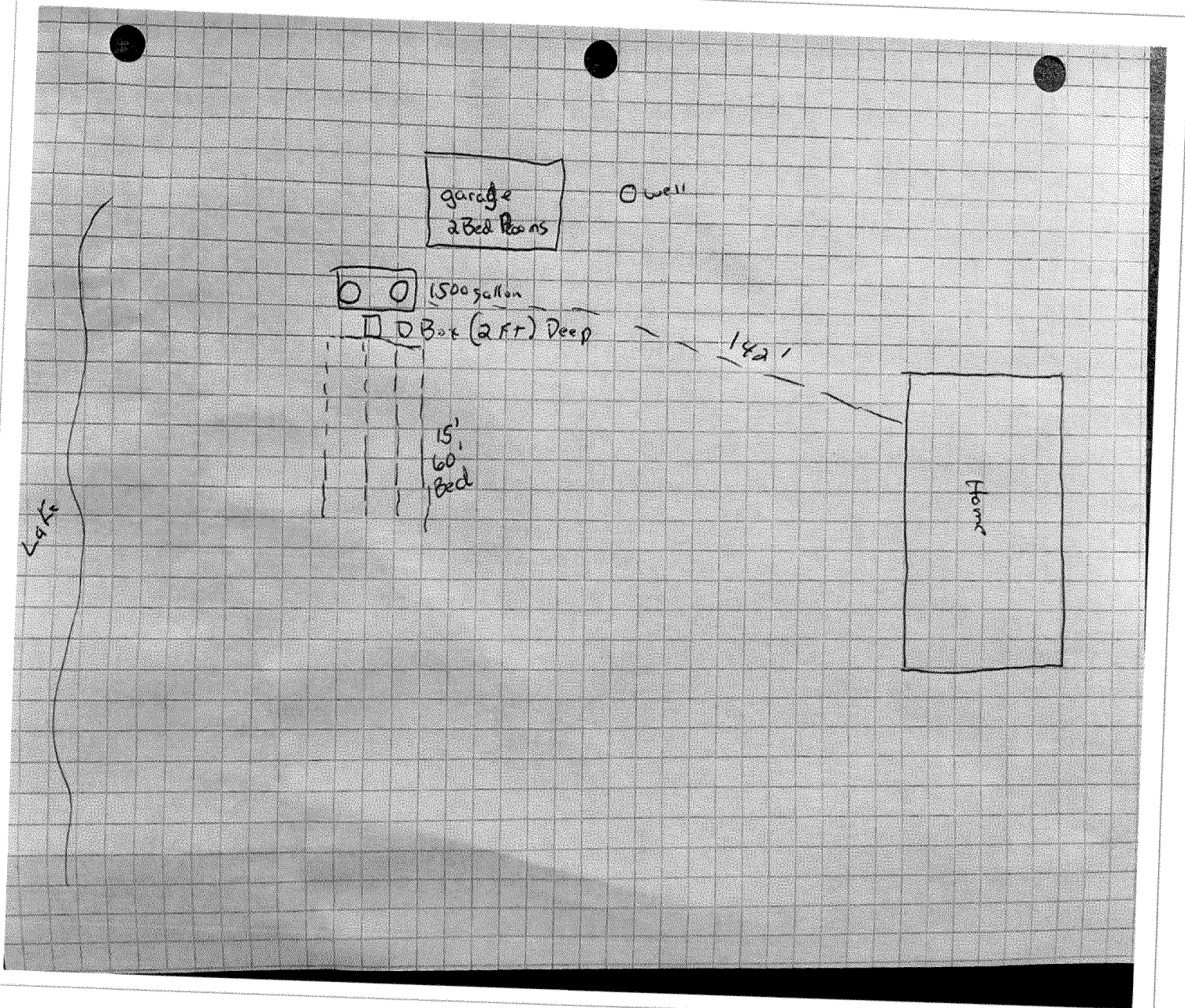

✓ 250 25 06 020 00

**DELAWARE COUNTY
BOARD OF SUPERVISORS** (Print or Type) Permit No. 1412

APPLICATION FOR PERMIT TO INSTALL PRIVATE SEWAGE DISPOSAL SYSTEM

ADDRESS: 26236 213th Ave Section 25 Township M16

LOCATION: NW 1/4 sec 25 T-88-N R-5-W

Owner: Ray Kessenich Tenant: _____ Plumber: Harbach

Lot Size: 300x250 Type Commercial: _____ Residential: (No. Bedrooms) _____

Fixtures: Sinks 3 Lavatories _____ Bath Tubs _____ Showers 3 Sinks 5 Automatic Laundry 1 Sump Pump _____

Septic Tank made by Swales Garbage Grinder _____ Construction Material concrete Gallons Cap. 1500

Percolation Test: 1 _____ 2 _____ 3 _____ 4 _____ Made by: _____

Absorption Field: Total length of laterals 15x60 No. of lateral lines _____

This system is new ☒ Existing _____ Garage & House

I certify that the above information is correct and that all proposed work will be completed in accordance with the Delaware County Regulations.

Date Approved 4-3-06 X M. J. G. [Signature]
By Dennis [Signature] INSPECTOR SEAL APPLICANT'S SIGNATURE

