

Recorded: 4/17/2025 at 10:24:49.0 AM
County Recording Fee:
Iowa E-Filing Fee: \$0.00
Combined Fee:
Revenue Tax: \$0.00
Delaware County, Iowa
Daneen Schindler RECORDER
BK: 2025 PG: 953

REAL ESTATE TRANSFER - GROUNDWATER HAZARD STATEMENT
TO BE COMPLETED BY TRANSFEROR

TRANSFEROR:

Name Allen W. Detweiler and Sarah R. Detweiler

Address	2834 285th Street	Hopkinton	IA	52237
	Number and Street or RR	City, Town or PO	State	Zip

TRANSFeree:

Name Herman Stutzman and Edna Stutzman

Address	2502 220th Ave	Dehli	IA	52223
	Number and Street or RR	City, Town or PO	State	Zip

Address of Property Transferred:

2834 285th Street, Hopkinton, IA 52237

Number and Street or RR	City, Town or PO	State	Zip
-------------------------	------------------	-------	-----

Legal Description of Property: (Attach if necessary)

Parcel 2021-61, Part of 2017-04 In SW-SW, 6-87N-3W, Delaware County, according to plat recorded in Book 2021, Page 1862

1. Wells (check one)

- ☐ There are no known wells situated on this property.
☒ There is a well or wells situated on this property. The type(s), location(s) and legal status are stated below or set forth on an attached separate sheet, as necessary.

2. Solid Waste Disposal (check one)

- ☒ There is no known solid waste disposal site on this property.
☐ There is a solid waste disposal site on this property and information related thereto is provided in Attachment #1, attached to this document.

3. Hazardous Wastes (check one)

- ☒ There is no known hazardous waste on this property.
☐ There is hazardous waste on this property and information related thereto is provided in Attachment #1, attached to this document.

4. Underground Storage Tanks (check one)

- ☒ There are no known underground storage tanks on this property. (Note exclusions such as small farm and residential motor fuel tanks, most heating oil tanks, cisterns and septic tanks, in instructions.)
☐ There is an underground storage tank on this property. The type(s), size(s) and any known substance(s) contained are listed below or on an attached separate sheet, as necessary.

5. Private Burial Site (check one)

- ☒ There are no known private burial sites on this property.
☐ There is a private burial site on this property. The location(s) of the site(s) and known identifying information of the decedent(s) is stated below or on an attached separate sheet, as necessary.

6. Private Sewage Disposal System (check one)

- ☐ All buildings on this property are served by a public or semi-public sewage disposal system.
☐ This transaction does not involve the transfer of any building which has or is required by law to have a sewage disposal system.
☒ There is a building served by private sewage disposal system on this property or a building without any lawful sewage disposal system. A certified inspector's report is attached which documents the condition of the private sewage disposal system and whether any modifications are required to conform to standards adopted by the Department of Natural Resources. A certified inspection report must be accompanied by this form when recording.
☐ There is a building served by private sewage disposal system on this property. Weather or other temporary physical conditions prevent the certified inspection of the private sewage disposal system from being conducted. The buyer has executed a binding acknowledgment with the county board of health to conduct a certified inspection of the private sewage disposal system at the earliest practicable time and to be responsible for any required modifications to the private sewage disposal system as identified by the certified inspection. A copy of the binding acknowledgment is attached to this form.
☐ There is a building served by private sewage disposal system on this property. The buyer has executed a binding acknowledgment with the county board of health to install a new private sewage disposal system on this property within an agreed upon time period. A copy of the binding acknowledgment is provided with this form.
☐ There is a building served by private sewage disposal system on this property. The building to which the sewage disposal system is connected will be demolished without being occupied. The buyer has executed a binding acknowledgment with the county board of health to demolish the building within an agreed upon time period. A copy of the binding acknowledgment is provided with this form. [Exemption #9]
☐ This property is exempt from the private sewage disposal inspection requirements pursuant to the following Exemption [Note: for exemption #9 use prior check box]: _____
☐ The private sewage disposal system has been installed within the past two years pursuant to permit number _____

Information required by statements checked above should be provided here or on separate sheets attached hereto:

Well is located approximately 25 feet straight North from the house

I HEREBY DECLARE THAT I HAVE REVIEWED THE INSTRUCTIONS FOR THIS FORM AND THAT THE INFORMATION STATED ABOVE IS TRUE AND CORRECT.

Signature: _____

(Transferor or Agent)

Telephone No.: _____

920-785-7064



IOWA DEPARTMENT OF NATURAL RESOURCES

GOVERNOR KIM REYNOLDS
LT. GOVERNOR CHRIS COUNOYER

DIRECTOR KAYLA LYON

TIME OF TRANSFER INSPECTION TOT# 14677 ROGER GROTH CERT # 8813

Site Information

Parcel Description: **410060001000**

Address: **2834 285th St., Hopkinton, IA 52237**

County: **Delaware**

Owner Information

Property is owned by a business: **No**

Business Name:

Owner Name: **Allen & Sarah Detweiler**

Email Address: **jfass@knightbarry.com**

Address: **2834 285th St, Hopkinton, IA 52237**

Phone No: **563-608-0178**

Site related information

No Of Bedrooms: **4**

Facility Type: **Residential**

Last Occupied:

Permit issued by County: **Yes**

All plumbing fixtures enter septic system: **Yes**

Property Information Comments:

Inspection Date: **04/08/2025**

Currently Occupied: **Yes**

System Installation Date: **05/15/2017**

Permit Number: **2613**

County contacted for records: **Yes**

Primary Treatment

Tank 1 Septic tank

Tank Name: **Tank 1 Septic tank**

Type: **Septic Tank**

Tank Size (Gal): **1,250**

Tank Material: **Concrete**

Tank Corrosion Type: **None**

Liquid Level Type: **Above Baffle**

No. of Compartments: **2**

Pump Tank Chamber: **No**

Licensed Pumper Name: **Groth Services LLC**

Date Pumped: **4/8/2025**

Meets Setback to Well: **Yes**

Well Type: **Private**

Distance To Well (Ft.): **>100'**

Is Accessible: **Yes**

Lid Intact: **Yes**

Risers Intact: **Yes**

Effluent Filter Present: **Yes**

Watertight: **Yes**

Tank/Vault Pumped: **Yes**

Inlet Baffle Present: **Yes**

Outlet Baffle Present: **Yes**

Functioning as Designed: **Yes**

Tank Comments: **Septic tank was overfull because the effluent filter was completely plugged. Also, the outlet line is exiting the tank at a very steep angle which raises the invert for outflow. This will be repaired next week by Groth Services.**

General Primary Treatment Comments:

Distribution Type

Distribution Box 1

Label: **Distribution Box 1**

Material Type: **Plastic**

Accessible: **No**

Box Opened: **Yes**

Baffle Present: **No**

Speed Levelers Present: **No**

Watertight: **Yes**

Functioning As Designed: **Yes**

General Distribution System Comments :

Secondary Treatment

Lateral Field1

Distribution Type: **Distribution Box**

Material Type: **Rock and PVC Pipe**

Trench Width: **36**

Lines: **2**

Total Length of Absorption Line: **200**

System Hydraulic Loaded: **Yes**

Gallons Loaded: **300.**

Meets Setback to Well: **Yes**

Well Type: **Private**

Distance To Well (Ft.): **>100'**

Lateral Lines Probed: **Yes**

Saturation or Ponding Present: **No**

Grass Cover Present: **No**

Lateral Lines Equal Length: **Yes**

System Located on Owner Property: **Yes**

Easement Present: **N/A**

Functioning as Designed: **Yes**

Comments: **Lateral field is very small for a four-bedroom home. There is a vegetable garden over most of the soil absorption system.**

General Secondary Treatment Comments:

Narrative Report

TOT Inspection Report Overall Narrative Comments: **This is a single story - 4-bedroom home on a slab w/o basement. The original install permit in 2017 was for a 2-bedroom home. There is a water softener and a kitchen garbage disposal that the current owner does not use. The 1250 gal. concrete septic tank is very shallow with one corner actually at surface. I would recommend adding a 6" riser to each existing then add 6" of soil. The outlet Pipe is exiting the tank at a very steep angle causing the septic tank to back up into the inlet line. We will repair the steep outlet pipe the week of April 14th. The distribution box is a "plastic only" box in very good condition. There are no speed levelers, but the 2 header pipes are taking water equally. The two 100' rock and pipe soil absorption lines are 36" wide. There was no sewage surfacing or ponding and probing showed no saturation. The system accepted the 300 gal. water load test w/o any slowness or backing up.**



IOWA DEPARTMENT OF NATURAL RESOURCES

GOVERNOR KIM REYNOLDS
LT. GOVERNOR CHRIS COURNOYER

DIRECTOR KAYLA LYON

TIME OF TRANSFER INSPECTION TOT# 14677 ROGER GROTH CERT # 8813

Owner Name: Allen & Sarah Detweiler

Address: 2834 285th St. , Hopkinton , IA 52237

County: Delaware

Inspection Date: 04/08/2025

Submitted Date: 4/12/2025

This page certifies a Time of Transfer inspection was conducted and submitted for the property listed above in accordance with Subrule 567 IAC 69.2(8).

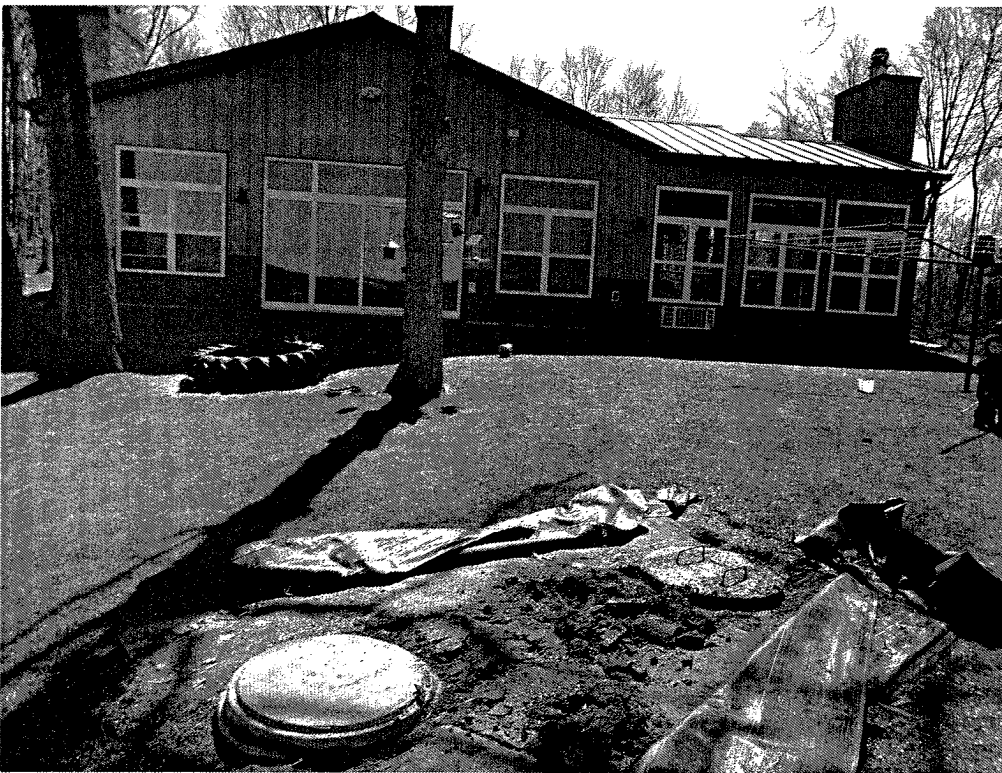



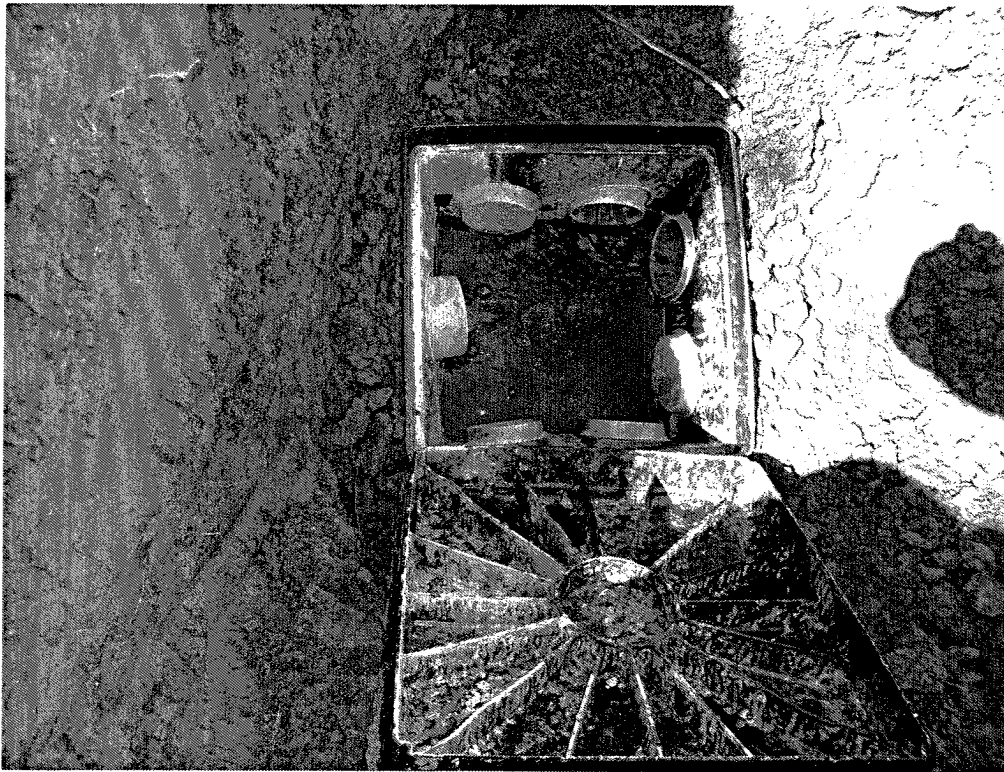

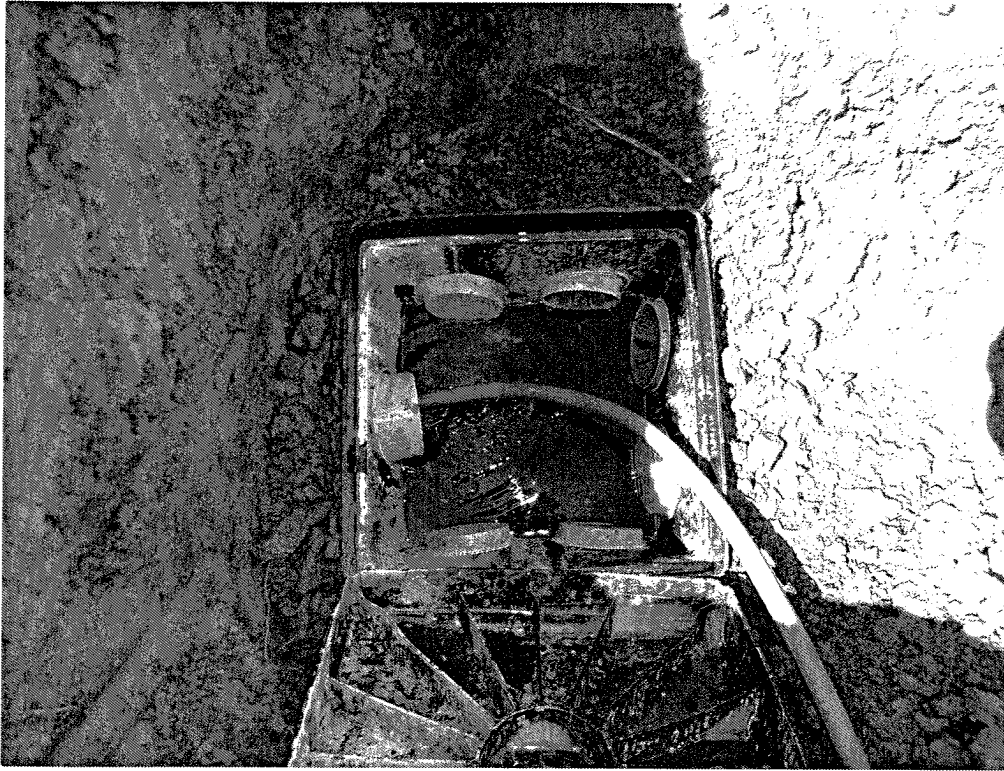

GROTH SERVICES

TOT MAP 4/08/2025
NAME Allen Detweiler
ADDRESS 2834 - 285th St.
High Winton, IA 52237
Delaware County

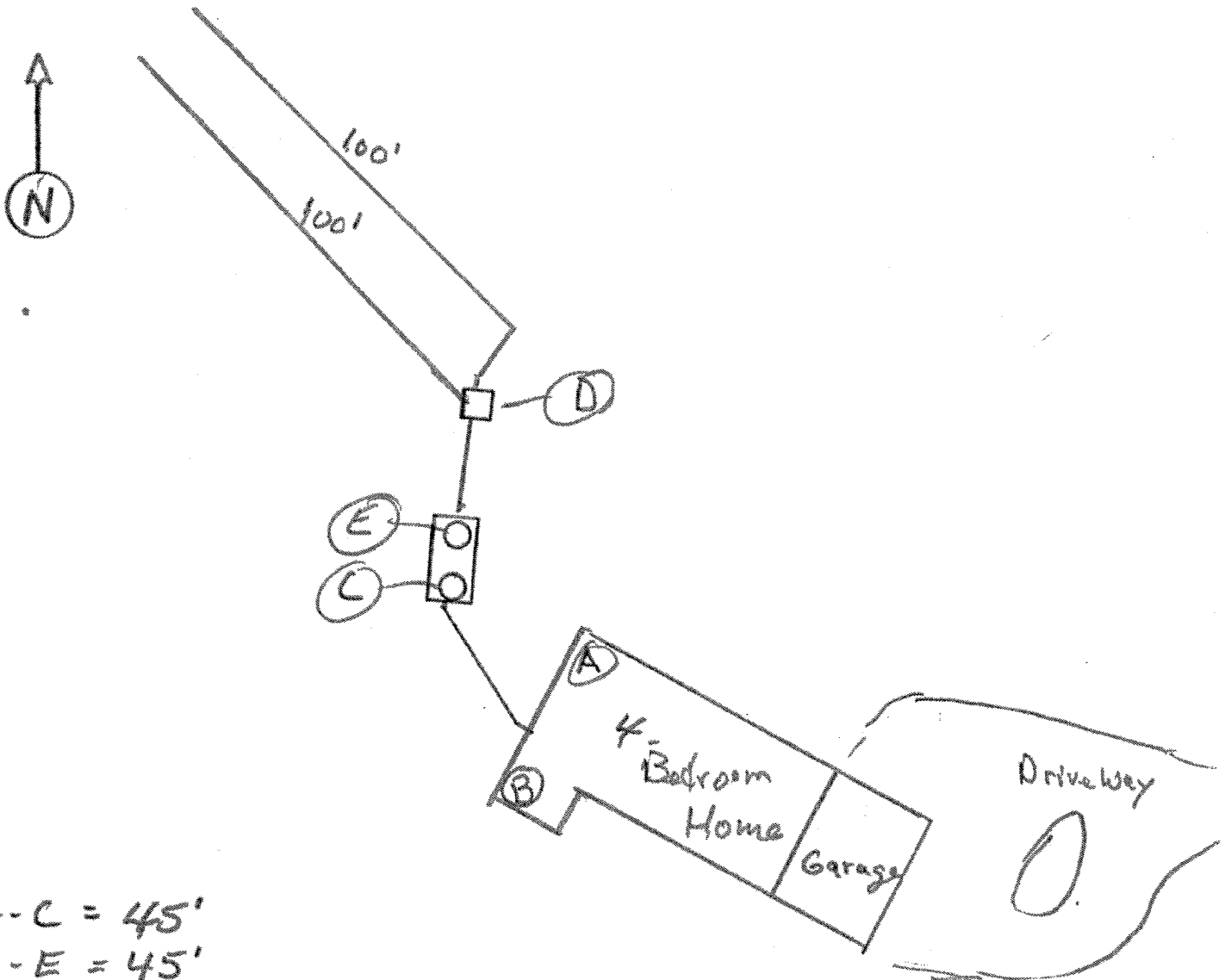

A-C = 45'
A-E = 45'
B-C = 52'
B-E = 46' 3"
A-D = 52' 2"
B-D = 67' 3"

1250 gal tank w/risers to surface

1- Effluent filter

D-Box is 22" deep

SAS is rock & pipe