



Daneen Schindler, RECORDER/REGISTRAR
DELAWARE COUNTY IOWA

PREPARED BY: RANDALL L. RATTENBORG 105 WEST MAIN STREET MANCHESTER, IA 52057, 563-927-2434

UNITED STATES PUBLIC LAND SURVEY CORNER CERTIFICATE

Land Survey Monuments situated in Section 8 , Township 87 North, Range 6 West of the Fifth Principal Meridian,
Delaware County, Iowa.

Previously recorded in County Recorder's Office in Center - Book 2006, Page 3883
(book, page, document number, etc.)

CENTER OF SECTION: Found 1/2" rebar w/orange cap #8419. This corner being re-tied due to missing tie objects.

NW CORNER SE 1/4 - SE 1/4: Set 1/2" rebar at the intersection of the line between the mathematical location of NW Corner SW 1/4 - SE 1/4 and NE Corner SE 1/4 - SE 1/4 and the north - south fence line. The theoretical location does not fit the field evidence.

SW CORNER SE 1/4 - SE 1/4: Set magnail w/steel cap #17939 at the theoretical location between the S 1/4 Corner and SE Corner.

PLAN VIEW

(Show a minimum of three reference ties to durable physical objects, relevant monuments and physical conditions that will enable recovery of the corner.)

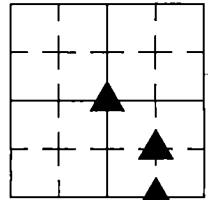
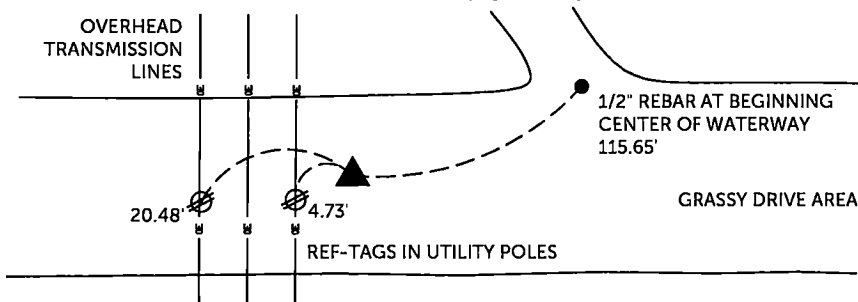

SECTION 8, T 87 N, R 6 W

CENTER OF SECTION
FOUND 1/2"Ø REBAR W/ORANGE CAP #8419

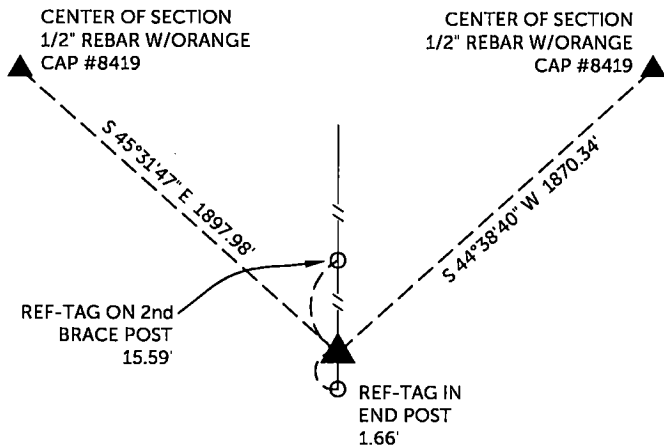

NW CORNER SE 1/4 - SE 1/4
SET 1/2" REBAR W/ORANGE CAP #17939

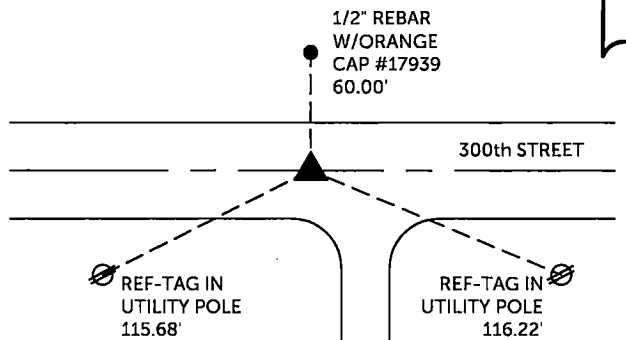

SW CORNER SE 1/4 - SE 1/4
SET MAGNAIL W/STEEL CAP #17939

TIES ARE TO PLAT PARCEL 2024-19 & 2024-20
IN SECTION 8, T 87 N, R 6 W

BURRINGTON GROUP, INC. PROJECT NO. 23-161

I HEREBY CERTIFY THAT THIS LAND SURVEYING DOCUMENT
WAS PREPARED AND THE RELATED SURVEY WORK WAS
PERFORMED BY ME OR UNDER MY DIRECT PERSONAL
SUPERVISION AND THAT I AM A DULY LICENSED PROFESSIONAL
LAND SURVEYOR UNDER THE LAWS OF THE STATE OF IOWA.

SEAL COVERS THIS SHEET ONLY

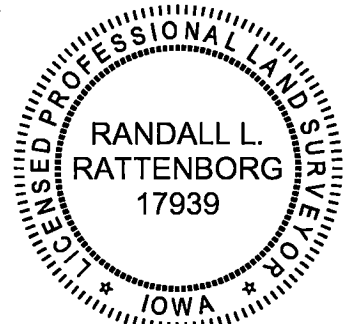

Randall L. Rattenborg, P.L.S. License #17939 Date 4/15/2024
My license renewal date is December 31, 2025
List Corners to be Indexed: Section 8 Township T 87 N Range R 6 W
CENTER
NW CORNER SE 1/4 - SE 1/4
SW CORNER SE 1/4 - SE 1/4



BURRINGTON GROUP, INC.
Civil Engineering | Land Surveying
105 W. Main Street Manchester, Iowa 52057