



Book 2023 Page 2406

Document 2023 GWH-2406 Type 53 001 Pages 11
Date 9/25/2023 Time 3:06:16PM
Rec Amt \$.00

Daneen Schindler, RECORDER/REGISTRAR
DELAWARE COUNTY IOWA

REAL ESTATE TRANSFER - GROUNDWATER HAZARD STATEMENT
TO BE COMPLETED BY TRANSFEROR

If the transaction is exempt from filing a declaration of value pursuant to Iowa Code 428A.1(2), **STOP HERE**. Pursuant to Iowa Code section 558.69(1), when no declaration of value is submitted during a transaction, you are not required to submit a groundwater hazard statement or include the statutory language in Iowa Code section 558.69(8A). Please consult your realtor or legal counsel for further advice, including on whether a declaration of value is required. The Department provides this information for statutory reference only.

Instructions for this document can be found at:

<https://www.iowadnr.gov/Portals/idnr/uploads/forms/5420960%20Instructions.pdf>

Attachment 1, if required, can be found at: <https://www.iowadnr.gov/Portals/idnr/uploads/forms/5420960a.pdf>

TRANSFEROR:

Name: David V. Hardin Sr. and Delma Hardin
Address: 2138 205th Ave, Manchester, IA 52057

TRANSFeree:

Name: Mitchell J. Peyton and Angela M. Peyton
Address: 800 Ridgewood Drive, Manchester, IA 52057

Address of Property Transferred:

21812 258th Street, Delhi, Iowa 52223

Legal Description of Property: (Attach if necessary)

Lot One (1) of Hartwick Lake Club North Fourth Subdivision A Subdivision Of Lot Two Of Hartwick Lake Club North, Second Subdivision Of Part Of The SE1/4 Of The SE1/4 And Of The NE1/4 Of The SE1/4 Except The North 10 Acres Thereof, All In Section 24, T88N, R5W Of The Fifth Principal Meridian, Delaware County, Iowa, according to plat recorded in Book 6 Plats, Page 176, and plat recorded in Book 2007, Page 3763.

and
All lake frontage running to the waterfront and then at right angles to the middle of Lake Delhi, also called Hartwick Lake, in respect to and adjoining said Lot One (1).

1. Wells (check one)

- No Condition - There are no known wells situated on this property.
- Condition Present - There is a well or wells situated on this property. The type(s), location(s) and legal status are stated below or set forth on an attached separate sheet, as necessary.

2. Solid Waste Disposal (check one)

- No Condition - There is no known solid waste disposal site on this property.
- Condition Present - There is a solid waste disposal site on this property and information related thereto is provided in Attachment #1, attached to this document.

3. Hazardous Wastes (check one)

- No Condition - There is no known hazardous waste on this property.
- Condition Present - There is hazardous waste on this property and information related thereto is provided in Attachment #1, attached to this document.

4. Underground Storage Tanks (check one)

- No Condition - There are no known underground storage tanks on this property. (Note exclusions such as small farm and residential motor fuel tanks, most heating oil tanks, cisterns and septic tanks, in instructions.)
- Condition Present - There is an underground storage tank on this property. The type(s), size(s) and any known substance(s) contained are listed below or on an attached separate sheet, as necessary.

5. Private Burial Site (check one)

- No Condition - There are no known private burial sites on this property.
- Condition Present - There is a private burial site on this property. The location(s) of the site(s) and known identifying information of the decedent(s) is stated below or on an attached separate sheet, as necessary.

6. Private Sewage Disposal System (check one)

- No Condition - All buildings on this property are served by a public or semi-public sewage disposal system.
- No Condition - This transaction does not involve the transfer of any building which has or is required by law to have a sewage disposal system.
- Condition Present - There is a building served by private sewage disposal system on this property or a building without any lawful sewage disposal system. A certified inspector's report is attached which documents the condition of the private sewage disposal system and whether any modifications are required to conform to standards adopted by the Department of Natural Resources. A certified inspection report must be accompanied by this form when recording.
- Condition Present - There is a building served by private sewage disposal system on this property. Weather or other temporary physical conditions prevent the certified inspection of the private sewage disposal system from being conducted. The buyer has executed a binding acknowledgment with the county board of health to conduct a certified inspection of the private sewage disposal system at the earliest practicable time and to be responsible for any required modifications to the private sewage disposal system as identified by the certified inspection. A copy of the binding acknowledgment is attached to this form.
- Condition Present - There is a building served by private sewage disposal system on this property. The system is failing to ensure effective wastewater treatment or is otherwise improperly functioning, and the buyer has executed a binding acknowledgment with the county board of health to install a new private sewage disposal system on this property within an agreed upon time period. A copy of the binding acknowledgment is provided with this form.
- Condition Present - There is a building served by private sewage disposal system on this property. The building to which the sewage disposal system is connected will be demolished without being occupied. The buyer has executed a binding acknowledgment with the county board of health to demolish the building within an agreed upon time period. A copy of the binding acknowledgment is provided with this form. [Exemption #7]
- Condition Present - There is a building served by private sewage disposal system on this property. This property is exempt from the private sewage disposal inspection requirements pursuant to the following Exemption [Note: for exemption #7 use prior check box]:

- Condition Present - There is a building served by private sewage disposal system on this property. The private sewage disposal system has been installed within the past two years pursuant to permit number:

Review the following two directions carefully:

A. If you selected a box stating "No Condition" for every numbered section above, STOP HERE. Do not submit this form. Instead, pursuant to Iowa Code section 558.69(8A), you must include the following language on the first page of the recorded deed, instrument, or other writing:

"There is no known private burial site, well, solid waste disposal site, underground storage tank, hazardous waste, or private sewage disposal system on the property as described in Iowa Code section 558.69, and therefore the transaction is exempt from the requirement to submit a groundwater hazard statement."

Please consult your realtor or legal counsel for further advice on this exemption. By law, the owner of the property is responsible for the accuracy of this statement, and the Department provides this information for statutory reference only.

B. If you checked any box stating "Condition Present" for any of the numbered sections above, continue below. You must complete this form, including providing all required information, and you must submit this form to the county recorder's office with declaration of value.

Information required by statements checked above should be provided here or on separate sheets attached hereto:

1- old, abandoned well site (sand point) SE end of the garage

I HEREBY DECLARE THAT I HAVE REVIEWED THE INSTRUCTIONS FOR THIS FORM AND THAT THE INFORMATION STATED ABOVE IS TRUE AND CORRECT.

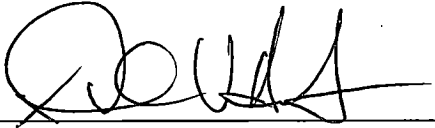
Signature: 

Telephone No.: 563 920 0800



TIME OF TRANSFER INSPECTION TOT# 6201 LUKE OGDEN CERT # 6715

Site Information

Parcel Description: **250240300110**

Address: **21812 258th St., Delhi, IA 52330**

County: **Delaware**

Owner Information

Property is owned by a business: **No**

Business Name:

Owner Name: **David Hardin Sr.**

Email Address:

Address: **2138 205th Ave., Manchester, IA 52057**

Phone No:

Site related information

No Of Bedrooms: **3**

Inspection Date: **07/07/2023**

Facility Type: **Residential**

Currently Occupied: **Yes**

Last Occupied:

System Installation Date: **09/30/2009**

Permit issued by County: **Yes**

Permit Number: **1738**

All plumbing fixtures enter septic system: **Yes**

County contacted for records: **Yes**

Property Information Comments:

Primary Treatment

Tank 1

Tank Name: **Tank 1**

Type: **Septic Tank**

Tank Size (Gal): **1250**

Tank Material: **Concrete**

Tank Corrosion Type: **Slight**

Liquid Level Type: **Normal**

No. of Compartments: **2**

Pump Tank Chamber: **No**

Licensed Pumper Name: **Groth Services**

Date Pumped: **7/7/2023**

Meets Setback to Well: **Yes**

Well Type: **Private**

Distance To Well (Ft): **>100'**

Is Accessible: **Yes**

Lid Intact: **Yes**

Risers Intact: **Yes**

Effluent Filter Present: **Yes**

Watertight: **Yes**

Tank/Vault Pumped: **Yes** Inlet Baffle Present: **Yes** Outlet Baffle Present: **Yes** Functioning as Designed: **Yes**

Tank Comments:

Tank 2

Tank Name: **Tank 2** Type: **Pump Tank** Tank Size (Gal): **500**
Tank Material: **Concrete** Tank Corrosion Type: **Slight** Liquid Level Type: **Normal**
No. of Compartments: **1** Pump Tank Chamber: **No** Licensed Pumper Name: **Groth Services**
Date Pumped: **7/7/2023** Meets Setback to Well: **Yes** Well Type: **Private**
Distance To Well (Ft.): **>100'** Is Accessible: **Yes** Lid Intact: **Yes**
Risers Intact: **Yes** Effluent Filter Present: Watertight: **Yes**
Tank/Vault Pumped: **Yes** Inlet Baffle Present: **Yes** Outlet Baffle Present: **No** Functioning as Designed: **Yes**

Tank Comments:

General Primary Treatment Comments:

Distribution Type

Distribution Box 1

Label: **Distribution Box 1** Material Type: **Plastic** Accessible: **Yes**
Box Opened: **Yes** Baffle Present: **No** Speed Levelers Present: **No**
Watertight: **Yes** Functioning As Designed: **Yes**

General Distribution System Comments : **7 Hole Distribution Box**

Secondary Treatment

Lateral Field1

Distribution Type: **Distribution Box** Material Type: **Leaching Chamber** Trench Width: **2'**
Lines: **4** Total Length of Absorption Line: **200** System Hydraulic Loaded: **Yes**
Gallons Loaded: **300** Meets Setback to Well: **Yes** Well Type: **Private**
Distance To Well (Ft.): **>100'** Lateral Lines Probed: **Yes** Saturation or Ponding Present: **No**
Grass Cover Present: **Yes** Lateral Lines Equal Length: **Yes** System Located on Owner Property: **Yes**
Easement Present: **N/A** Functioning as Designed: **Yes**

Comments:

General Secondary Treatment Comments:

Narrative Report

TOT Inspection Report Overall Narrative Comments: **See Uploaded Files**

Based on what we were able to observe and our experience with on-site wastewater technology, we submit this sanitary sewage disposal system inspection report based on the present condition of the on-site sewage disposal system. Oasis Pump Service has not been retained to warrant, guarantee, or certify the proper functioning of the system for any period of time in the future. Because of numerous factors (usage, soil characteristics, previous failures, etc.) which effect the proper operation of a septic system as well as the inability of our Company to supervise or monitor the use or maintenance of the system, this report shall not be constructed as a warranty by our Company that the system will function properly for any particular buyer. Oasis Pump Service DISCLAIMS ANY WARRANTY, either expressed or implied, arising from the inspection of the septic system or this report. We are also not ascertaining the impact the system is having on the ground water.

I have studied the information contained herein and that my assessment is honest, thorough, and, to the best of my ability correct.



TIME OF TRANSFER INSPECTION TOT# 6201 LUKE OGDEN CERT # 6715

Owner Name: David Hardin Sr.

Address: 21812 258th St. , Delhi , IA 52330

County: Delaware

Inspection Date: 07/07/2023

Submitted Date: 7/20/2023

This page certifies a Time of Transfer inspection was conducted and submitted for the property listed above in accordance with Subrule 567 IAC 69.2(8).

✓ 250-24-03-001-10

NO Charge
- 91.36739

Re 10 25)

DELAWARE COUNTY 42.41477 (Print or Type) Permit No. 1738
BOARD OF SUPERVISORS

APPLICATION FOR PERMIT TO INSTALL PRIVATE SEWAGE DISPOSAL SYSTEM

ADDRESS: 21812 - 258+2 St Section 24 Township M.16

LOCATION: SE 1/4 Sec 24 T-88-N R.5-W

Owner: Dave Hardin Tenant: Plumber: Hart

Lot Size: 100x150 Type Commercial: Residential: (No. Bedrooms) 3

Fixtures: Sinks 3 Lavatories 2 Bath Tubs 2 Showers 1 Sinks 4 Automatic Laundry 1 Sump Pump 2.00 p.m.p
Add'l. 1/2

Septic Tank made by Sewer Garbage Grinder Construction Material Gallons Cap. 500

Percolation Test: 1 2 3 4 Made by:

Absorption Field: Total length of laterals 20x35' No. of lateral lines 7.5 is a part of in

This system is new Existing

I certify that the above information is correct and that all proposed work will be completed in accordance with the

Delaware County Regulations.

Date Approved 9-30-09

By Robert Lewis SEAL APPLICANT'S SIGNATURE
INSPECTOR



1332 N. Franklin, Manchester, Iowa 52057
563-927-6503 888-666-6503
www.oasiswell.com

OWNER: Dave Hardin

DATE: 7/7/2023

SITE ADDRESS: 21812 258th St

TOWN/COUNTY: Delhi / Delaware

GPS: Long: -91.36734 Lat: 42.41477

TANK SIZE: 1250 / 500 pump Plastic OR Concrete

D-BOX: 0 or 9 OUTLETS USED: 4

SECONDARY TREATMENT: 4-50' lines total 200' Infiltrator
3" lines to infiltrator

pump tank + leach field installed 9/30/2009 Permit # 1738

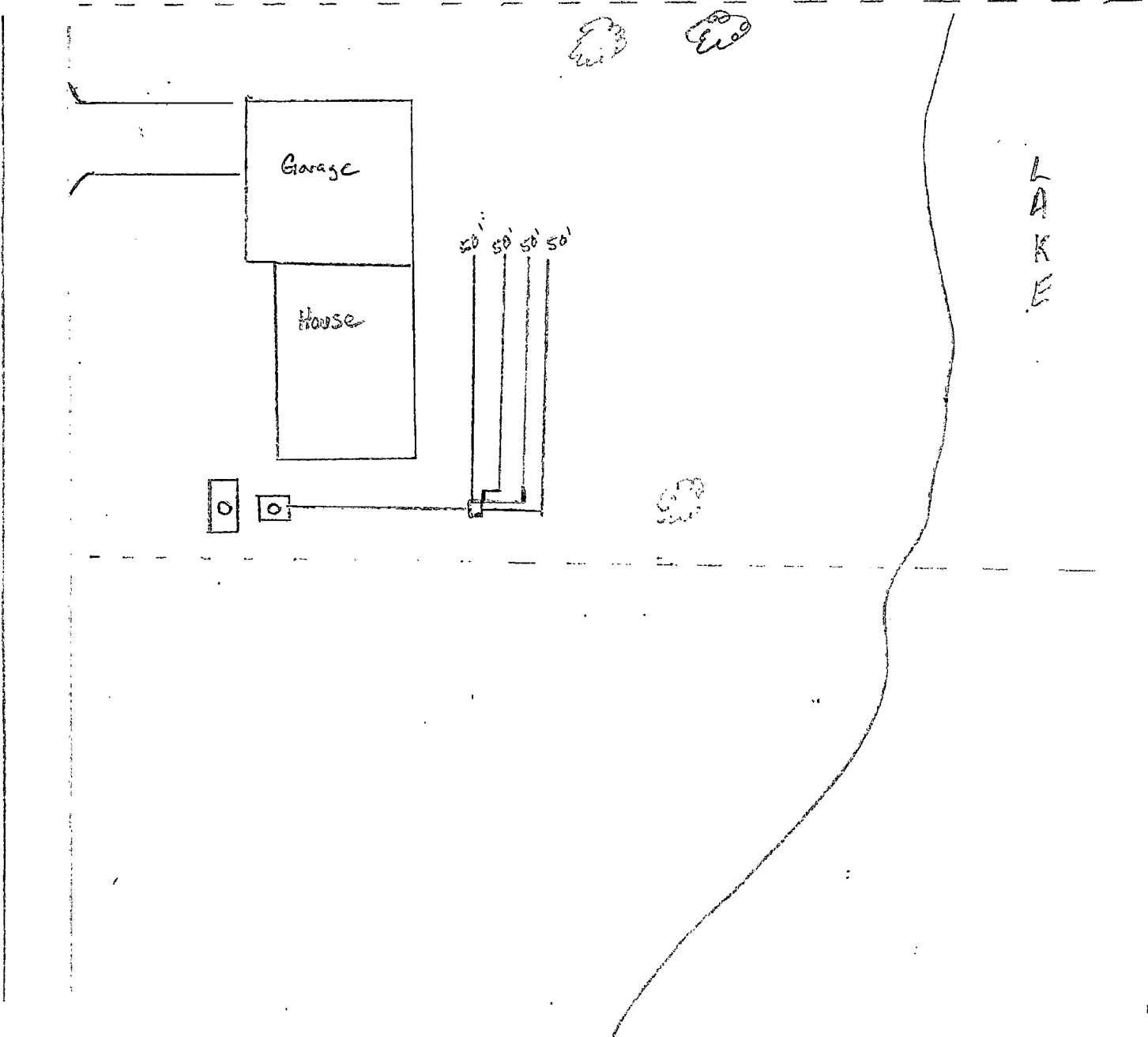



1332 N. Franklin, Manchester, Iowa 52057
563-927-6503
www.oasiswell.com

Septic Inspection

David Hardin
21812 258th St.
Delhi, IA 52330

Home Description:

Home is a 3-bedroom, 2½ bath home with approximately 1500 sq. ft. Home was built in 1990, water softener present and plumbing goes out under the basement floor.

Septic Description:

Septic system consists of 1 – 1250-gallon 2 compartment concrete septic tank, 1 – 500-gallon pump tank with lift pump. System has an effluent filter and alarm for lift pump system. Leach field consist of 4 – 50' long lines of Infiltrator. Pump tank, lift pump and leach field were installed September 30, 2009. Permit #1738

Company Disclaimer

Based on what we were able to observe and our experience with on-site wastewater technology, we submit this sanitary sewage disposal system inspection report based on the present condition of the on-site sewage disposal system. Oasis Pump Service has not been retained to warrant, guarantee, or certify the proper functioning of the system for any period of time in the future. Because of numerous factors (usage, soil characteristics, previous failures, etc.) which effect the proper operation of a septic system as well as the inability of our Company to supervise or monitor the use or maintenance of the system, this report shall not be constructed as a warranty by our Company that the system will function properly for any particular buyer. Oasis Pump Service **DISCLAIMS ANY WARRANTY**, either expressed or implied, arising from the inspection of the septic system or this report. We are also not ascertaining the impact the system is having on the ground water.

I have studied the information contained herein and that my assessment is honest, thorough, and, to the best of my ability correct.

Certified by Luke Ogden #6715

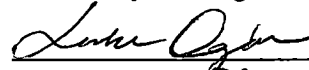

L.O.

Date 7/7/23

Owner: David Hardin 21812 258th St. Delhi, IA 52330

