

Recorded: 7/10/2023 at 10:39:04.0 AM
County Recording Fee: \$0.00
Iowa E-Filing Fee: \$0.00
Combined Fee: \$0.00
Revenue Tax:
Delaware County, Iowa
Daneen Schindler RECORDER
BK: 2023 PG: 1556

REAL ESTATE TRANSFER - GROUNDWATER HAZARD STATEMENT
TO BE COMPLETED BY TRANSFEROR

If the transaction is exempt from filing a declaration of value pursuant to Iowa Code 428A.1(2), **STOP HERE**. Pursuant to Iowa Code section 558.69(1), when no declaration of value is submitted during a transaction, you are not required to submit a groundwater hazard statement or include the statutory language in Iowa Code section 558.69(8A). Please consult your realtor or legal counsel for further advice, including on whether a declaration of value is required. The Department provides this information for statutory reference only.

Instructions for this document can be found at:

<https://www.iowadnr.gov/Portals/idnr/uploads/forms/5420960%20Instructions.pdf>

Attachment 1, if required, can be found at: <https://www.iowadnr.gov/Portals/idnr/uploads/forms/5420960a.pdf>

TRANSFEROR:

Name: Mary K Sheppard and Steven J. Sheppard
Address: 2120 330th Street, Coggon, IA 52218

TRANSFeree:

Name: Michael Panoske and Abigail Panoske
Address: 4332 Pintail Drive, Marion, IA 52302

Address of Property Transferred:
20788 247th Street, Delhi, IA 52223

Lot Two (2) of Petlon's River Subdivision of part of the Southeast Quarter (SE1/4) of the Southeast Quarter (SE1/4) of Section Fourteen (14), Township Eighty Eight (88) North, Range Five (5), West of the Fifth Principal Meridian, Delaware County, Iowa, according to plat recorded in Book 6 Plats, Page 43 and plat recorded in Book 1999, Page 1573, except Parcel 2018-49, Part of Lot 2 Of Petlon's River Subdivision; In the SE1/4 - SE1/4 Of Section 14, T88N, R5W of the Fifth P.M., Delaware County, Iowa, according to plat recorded in Book 2018, Page 1649; also all lake frontage running to the waterfront and at right angles to the middle of Lake Delhi in respect to said Lot Two (2); also Parcel 2018-51, Par Of Parcel A In Lot 10 of Petlon's River Subdivision; In The SE1/4- SE1/4 of Section 14, T88N, R5W of the Fifth P.M., Delaware County, Iowa, according to plat recorded in Book 2018, Page 1649

1. Wells (check one)

- No Condition - There are no known wells situated on this property.
- Condition Present - There is a well or wells situated on this property. The type(s), location(s) and legal status are stated below or set forth on an attached separate sheet, as necessary.

2. Solid Waste Disposal (check one)

- No Condition - There is no known solid waste disposal site on this property.
- Condition Present - There is a solid waste disposal site on this property and information related thereto is provided in Attachment #1, attached to this document.

3. Hazardous Wastes (check one)

- No Condition - There is no known hazardous waste on this property.
- Condition Present - There is hazardous waste on this property and information related thereto is provided in Attachment #1, attached to this document.

4. Underground Storage Tanks (check one)

- No Condition - There are no known underground storage tanks on this property. (Note exclusions such as small farm and residential motor fuel tanks, most heating oil tanks, cisterns and septic tanks, in instructions.)
- Condition Present - There is an underground storage tank on this property. The type(s), size(s) and any known substance(s) contained are listed below or on an attached separate sheet, as necessary.

5. Private Burial Site (check one)

- No Condition - There are no known private burial sites on this property.
- Condition Present - There is a private burial site on this property. The location(s) of the site(s) and known identifying information of the decedent(s) is stated below or on an attached separate sheet, as necessary.

6. Private Sewage Disposal System (check one)

- No Condition - All buildings on this property are served by a public or semi-public sewage disposal system.
- No Condition - This transaction does not involve the transfer of any building which has or is required by law to have a sewage disposal system.
- Condition Present - There is a building served by private sewage disposal system on this property or a building without any lawful sewage disposal system. A certified inspector's report is attached which documents the condition of the private sewage disposal system and whether any modifications are required to conform to standards adopted by the Department of Natural Resources. A certified inspection report must be accompanied by this form when recording.
- Condition Present - There is a building served by private sewage disposal system on this property. Weather or other temporary physical conditions prevent the certified inspection of the private sewage disposal system from being conducted. The buyer has executed a binding acknowledgment with the county board of health to conduct a certified inspection of the private sewage disposal system at the earliest practicable time and to be responsible for any required modifications to the private sewage disposal system as identified by the certified inspection. A copy of the binding acknowledgment is attached to this form.
- Condition Present - There is a building served by private sewage disposal system on this property. The system is failing to ensure effective wastewater treatment or is otherwise improperly functioning, and the buyer has executed a binding acknowledgment with the county board of health to install a new private sewage disposal system on this property within an agreed upon time period. A copy of the binding acknowledgment is provided with this form.
- Condition Present - There is a building served by private sewage disposal system on this property. The building to which the sewage disposal system is connected will be demolished without being occupied. The buyer has executed a binding acknowledgment with the county board of health to demolish the building within an agreed upon time period. A copy of the binding acknowledgment is provided with this form. [Exemption #7]
- Condition Present - There is a building served by private sewage disposal system on this property. This property is exempt from the private sewage disposal inspection requirements pursuant to the following Exemption [Note: for exemption #7 use prior check box]:
less than 2 years
- Condition Present - There is a building served by private sewage disposal system on this property. The private sewage disposal system has been installed within the past two years pursuant to permit number:

Review the following two directions carefully:

- A. If you selected a box stating "No Condition" for every numbered section above, **STOP HERE**. Do not submit this form. Instead, pursuant to Iowa Code section 558.69(8A), you must include the following language on the first page of the recorded deed, instrument, or other writing:

"There is no known private burial site, well, solid waste disposal site, underground storage tank, hazardous waste, or private sewage disposal system on the property as described in Iowa Code section 558.69, and therefore the transaction is exempt from the requirement to submit a groundwater hazard statement."

Please consult your realtor or legal counsel for further advice on this exemption. By law, the owner of the property is responsible for the accuracy of this statement, and the Department provides this information for statutory reference only.

- B. If you checked any box stating "Condition Present" for any of the numbered sections above, continue below. You must complete this form, including providing all required information, and you must submit this form to the county recorder's office with declaration of value.

Information required by statements checked above should be provided here or on separate sheets attached hereto:

I HEREBY DECLARE THAT I HAVE REVIEWED THE INSTRUCTIONS FOR THIS FORM AND THAT THE INFORMATION STATED ABOVE IS TRUE AND CORRECT.

Signature: Mary Sheppard Telephone No.: 563-920-8447

Location of well
South of house

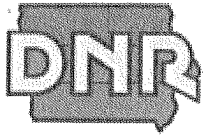

TIME OF TRANSFER INSPECTION TOT# 325 LUKE OGDEN CERT # 6715

Site Information

Parcel Description: **250140600210**

Address: **20788 247th st, Delhi, IA 52223**

County: **Delaware**

Owner Information

Property is owned by a business: **No**

Business Name:

Owner Name: **Joel and Judith Eckman**

Email Address:

Address: **20788 247th st, Delhi, IA 52223**

Phone No: **319-325-1233**

Site related information

No Of Bedrooms: **3**

Facility Type: **Residential**

Last Occupied:

Permit issued by County: **Yes**

All plumbing fixtures enter septic system: **Yes**

Property Information Comments:

Inspection Date: **05/09/2022**

Currently Occupied: **Yes**

System Installation Date: **03/13/2007**

Permit Number: **1499**

County contacted for records: **Yes**

Primary Treatment

Tank 1

Tank Name: **Tank 1**

Type: **Septic Tank**

Tank Size (Gal): **1000**

Tank Material: **Concrete**

Tank Corrosion Type: **Slight**

Liquid Level Type: **Normal**

No. of Compartments: **2**

Pump Tank Chamber: **Yes**

Licensed Pumper Name: **d&s st-49**

Date Pumped: **5/9/2022**

Meets Setback to Well: **Yes**

Well Type: **Private**

Distance To Well (Ft.): **>50'**

Is Accessible: **Yes**

Lid Intact: **Yes**

Risers Intact: **Yes**

Effluent Filter Present: **No**

Watertight: **Yes**

Tank/Vault Pumped: **Yes** Inlet Baffle Present: **Yes** Outlet Baffle Present: **Yes** Functioning as Designed: **Yes**
Tank Comments:

Tank 2

Tank Name: **Tank 2** Type: **Septic Tank** Tank Size (Gal): **1000**
Tank Material: **Concrete** Tank Corrosion Type: **Slight** Liquid Level Type: **Normal**
No. of Compartments: **2** Pump Tank Chamber: **No** Licensed Pumper Name: **D&S st-49**
Date Pumped: **5/9/2022** Meets Setback to Well: **Yes** Well Type: **Private**
Distance To Well (Ft.): **>100'** Is Accessible: **Yes** Lid Intact: **Yes**
Risers Intact: **Yes** Effluent Filter Present: **No** Watertight: **Yes**
Tank/Vault Pumped: **Yes** Inlet Baffle Present: **Yes** Outlet Baffle Present: **Yes** Functioning as Designed: **Yes**
Tank Comments:

General Primary Treatment Comments:

Distribution Type

Distribution Box 1

Label: **Distribution Box 1** Material Type: **Plastic and Concrete** Accessible: **No**
Box Opened: **Yes** Baffle Present: **No** Speed Levelers Present: **No**
Watertight: **Yes** Functioning As Designed: **Yes**

General Distribution System Comments :

Secondary Treatment

Absorption Bed1

Distribution Type: **Distribution Box** Material Type: **Rock and PVC Pipe** Absorption Bed Width: **25**
Absorption Bed Length: **30** Total Absorption Area: **750** System Hydraulic Loaded: **Yes**
Gallons Loaded: **300** Meets Setback to Well: **Yes** Well Type: **Private**
Distance To Well (Ft.): **<100'** Absorption Bed Probed: **Yes** Saturation or Ponding Present: **No**
Grass Cover Present: **Yes** System Located on Owner Property: **Yes** Easement Present: **N/A**
Functioning as Designed: **Yes**
Comments:

General Secondary Treatment Comments:

Narrative Report

TOT Inspection Report Overall Narrative Comments: **Uploaded a separate narrative report document.**





TIME OF TRANSFER INSPECTION TOT# 325 LUKE OGDEN CERT # 6715

Owner Name: **Joel and Judith Eckman**

Address: **20788 247th st , Delhi , IA 52223**

County: **Delaware**

Inspection Date: **05/09/2022**

Submitted Date: **05/15/2022**

1250 1406 002 10

~~W.P.~~ Ad.

DELAWARE COUNTY
BOARD OF SUPERVISORS

(Print or Type) Permit No. 1499

APPLICATION FOR PERMIT TO INSTALL PRIVATE SEWAGE DISPOSAL SYSTEM

ADDRESS: 20709 24th St Section 14 Township Milo

LOCATION: sec 14 T-88-N R-5-W

Owner: Joe Eckman Tenant: _____ Plumber: Harbach

Lot Size: _____ Type Commercial: _____ Residential: (No. Bedrooms) _____

Fixtures: Sinks 2 Lavatories 2 Bath Tubs 3 Showers 2 Sinks 4 Automatic Laundry _____ Sump Pump _____

Septic Tank made by _____ Garbage Grinder _____ Construction Material _____ Gallons Cap. 2 / 1000 -

Percolation Test: 1. _____ 2. _____ 3. _____ 4. _____ Made by: _____

Absorption Field: Total length of laterals 20x40 No. of lateral lines _____

This system is new Existing

I certify that the above information is correct and that all proposed work will be completed in accordance with the Delaware County Regulations.

Date Approved 3-13-07

By Dennis [Signature]
INSPECTOR

[Signature]
APPLICANT'S SIGNATURE

SEAL

doing a lot of ground work first

Site Evaluation Map

Designer

Harbach

List any construction issues:

Joe Eckman

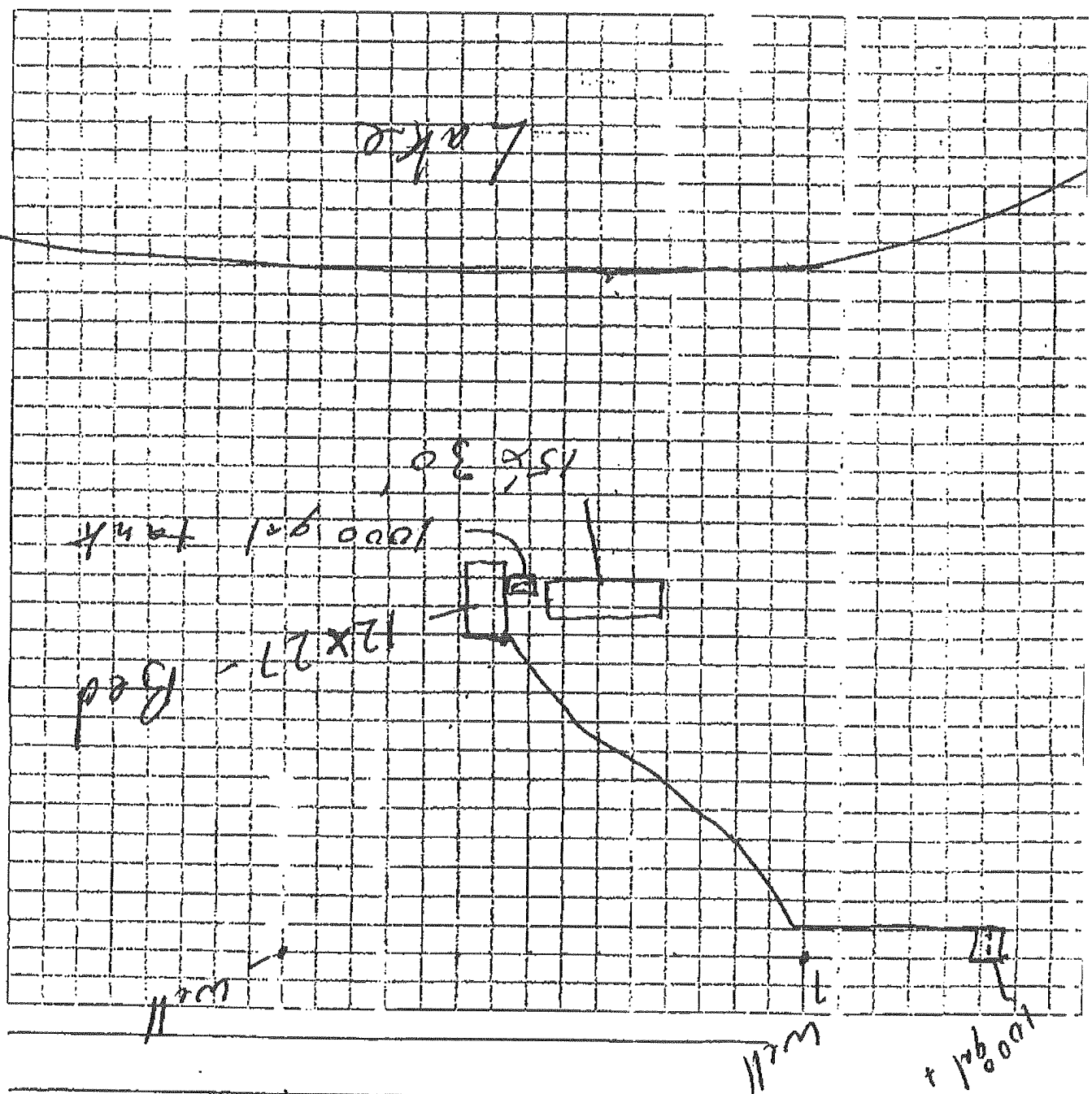

Mapping Checklist

- Map scale: _____
- Locate _____
- lot dimensions/proj. epty lines _____
- dwellings and other improvem. pts _____
- existing and/or prop. used syst. (s) _____
- replacement area _____
- unsuitable area(s) _____
- public water supply wells _____
- pumping access _____
- inner wellhead zone: _____
- _____ easements
- _____ phone
- _____ electric
- _____ gas
- _____ elevations
- _____ borings
- _____ benchmark
- _____ perc tests
- _____ horz/vert reference pts
- _____ setbacks
- _____ building
- _____ all water walls within 100ft
- _____ pressure pipe
- _____ water suction pipe
- _____ streams, lakes, rivers
- _____ floodway and fringe

indicate north _____

show slope _____

% direction _____



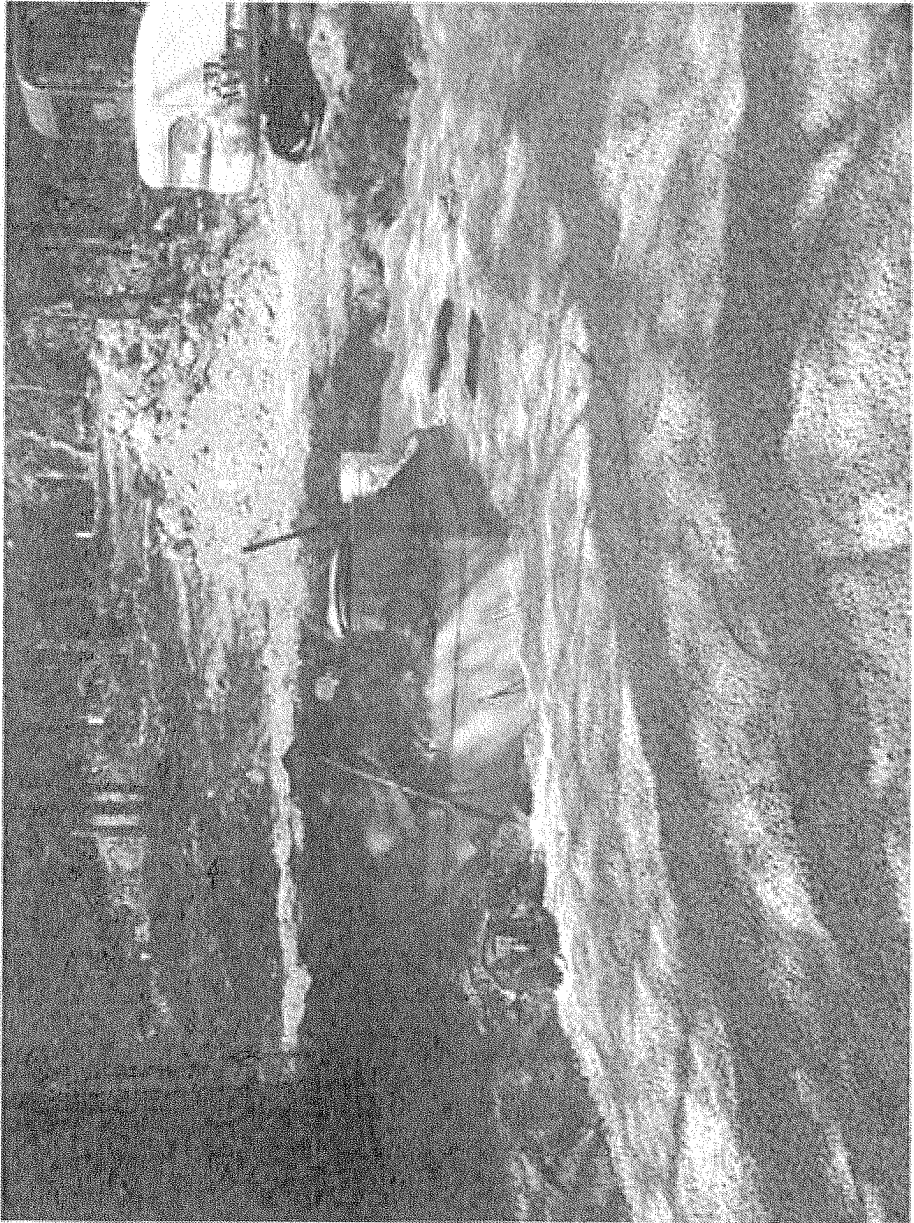

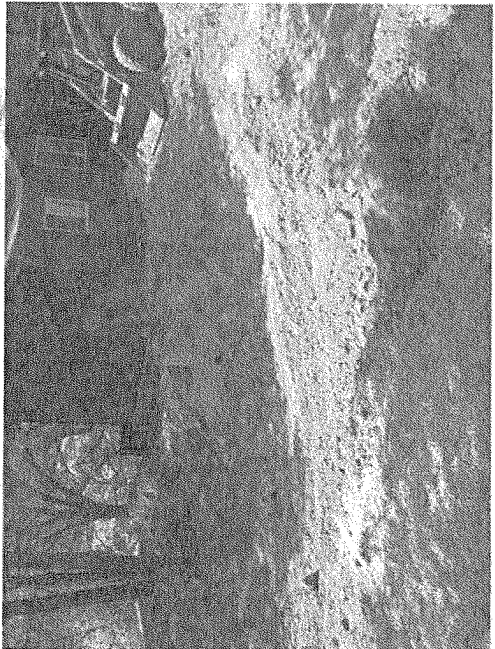
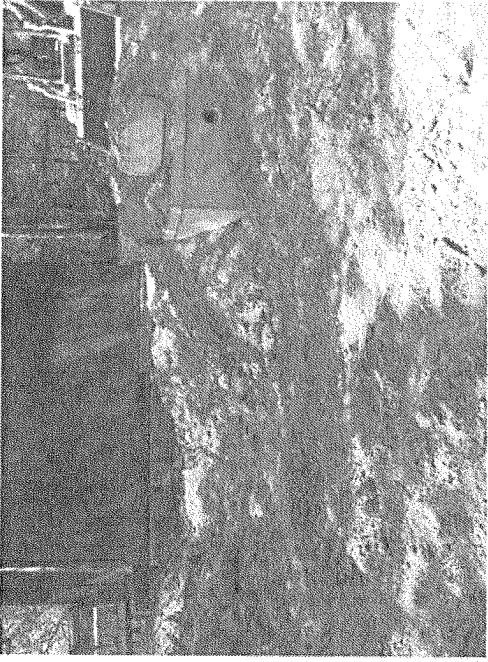



House septic
 Garage septic



OWNER: Joel + Judith Eckman

DATE: 5/9/2022

SITE ADDRESS: 20788 247th St.

TOWN/COUNTY: Delhi (Delaware)

GPS: Long: _____ Lat: _____

TANK SIZE: 2- 1000 gal Plastic OR Concrete

D-BOX: (7) or 9 OUTLETS USED: 6

SECONDARY TREATMENT: Rock + Pipe

House septic + Garage septic

House septic 2- 1000 gal. 2 comp. tanks Approx. 700 sq ft Bed.

Garage septic 1- 1250 gal 2 comp tank. 10x20 Bed



- A-1 119'
- A-2 121'
- A-3 124'
- B-1 138
- B-2 141'
- B-3 143'
- C-4 = 7'
- C-5 11'
- D-4 33'
- D-5 35'

- A-1 = 19' 6"
- A-2 = 22' 6"
- A-3 = 27' 4"
- B-1 = 32' 5"
- B-2 = 33' 6"
- B-3 = 35' 8"

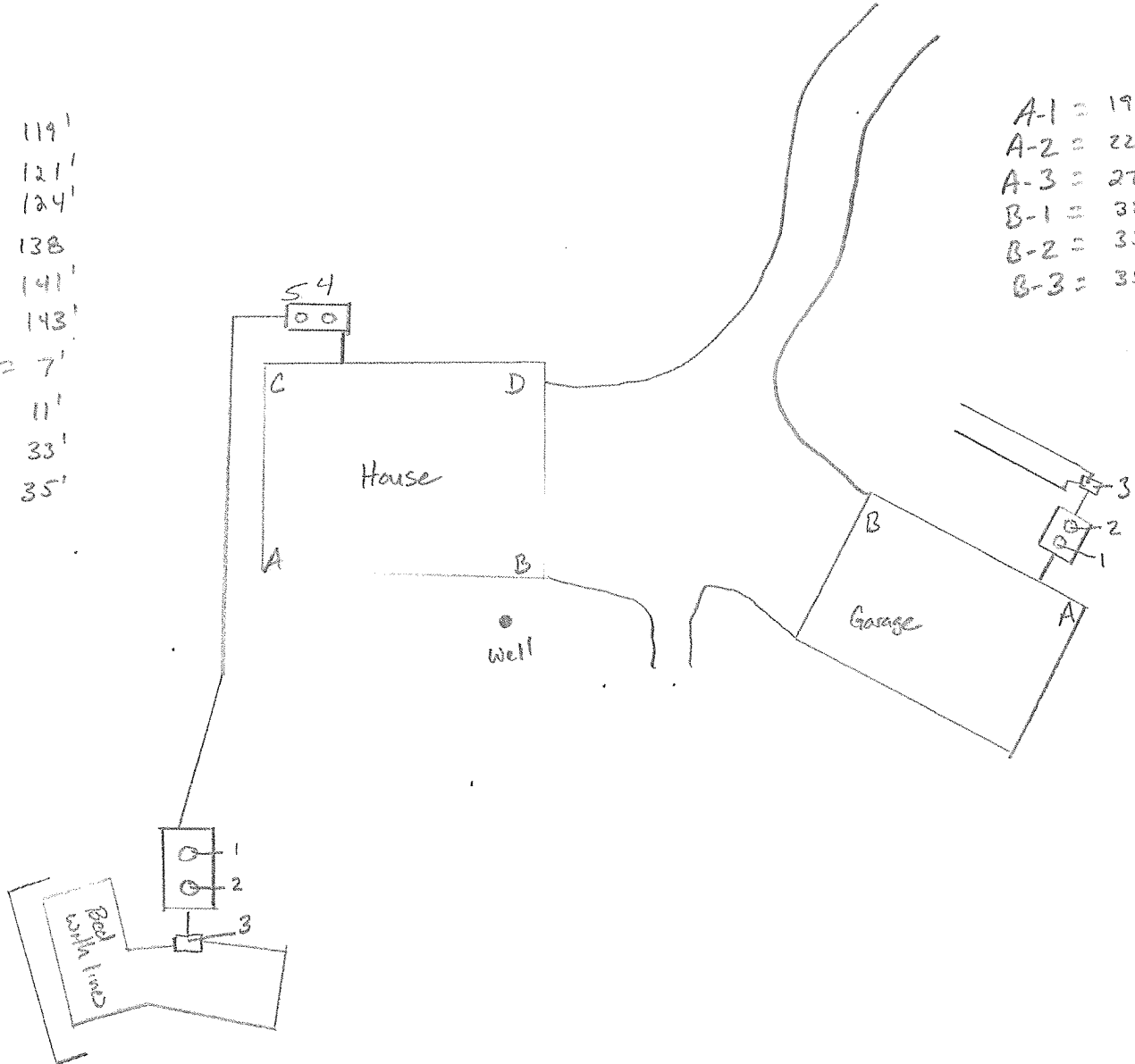



1332 N. Franklin, Manchester, Iowa 52057
563-927-6503 888-666-6503
www.oasiswell.com

Septic Inspection

Joel & Judy Eckman
20788 247th St.
Delhi, IA 52223

Home Description:

Home has 3 bedrooms, 2 bathrooms, with a water softener. Home was built in 2007 and has a gross living area of approximately 1175 sq. ft.

Septic Description:

Septic system for the home was installed in 2007, has 2 – 1000-gallon 2 compartment concrete tanks, 1 – 7-hole distribution box and approximately 700 sq. ft. of leach bed. Baffles are in good shape; distribution box is in good shape.

Septic Condition:

Septic tank and distribution box are in good shape. Load test was performed and 300 gallons of water was run through the leach bed and accepted water.

Company Disclaimer

Based on what we were able to observe and our experience with on-site wastewater technology, we submit this sanitary sewage disposal system inspection report based on the present condition of the on-site sewage disposal system. Oasis Pump Service has not been retained to warrant, guarantee, or certify the proper functioning of the system for any period of time in the future. Because of numerous factors (usage, soil characteristics, previous failures, etc.) which effect the proper operation of a septic system as well as the inability of our Company to supervise or monitor the use or maintenance of the system, this report shall not be constructed as a warranty by our Company that the system will function properly for any particular buyer. Oasis Pump Service **DISCLAIMS ANY WARRANTY**, either expressed or implied, arising from the inspection of the septic system or this report. We are also not ascertaining the impact the system is having on the ground water.

I have studied the information contained herein and that my assessment is honest, thorough, and, to the best of my ability correct.

Certified by Luke Ogden #6715

Luke Ogden Date 5/15/32
FO.

Owner: Joel & Judy Eckman 20788 247th St. Delhi, IA 52223

