



Book 2023 Page 1406

Document 2023 1406 Type 06 007 Pages 1  
Date 6/22/2023 Time 3:21:40PM  
Rec Amt \$7.00

Daneen Schindler, RECORDER/REGISTRAR  
DELAWARE COUNTY IOWA

*dy*

PREPARED BY: RANDALL L. RATTENBORG 105 WEST MAIN STREET MANCHESTER, IA 52057, 563-927-2434

# UNITED STATES PUBLIC LAND SURVEY CORNER CERTIFICATE

Land Survey Monuments situated in Section 17, Township 89 North, Range 3 West of the Fifth Principal Meridian,  
Delaware County, Iowa.

Previously recorded in County Recorder's Office in None  
(book, page, document number, etc.)

E 1/4 Corner, Set Stainless Steel Washer PLS 17939 by extending a line from the west quarter corner to the center of section to the center line of 300th Avenue.

## PLAN VIEW

(Show a minimum of three reference ties to durable physical objects, relevant monuments and physical conditions that will enable recovery of the corner.)

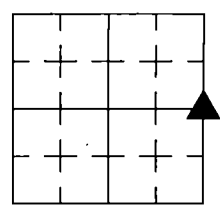
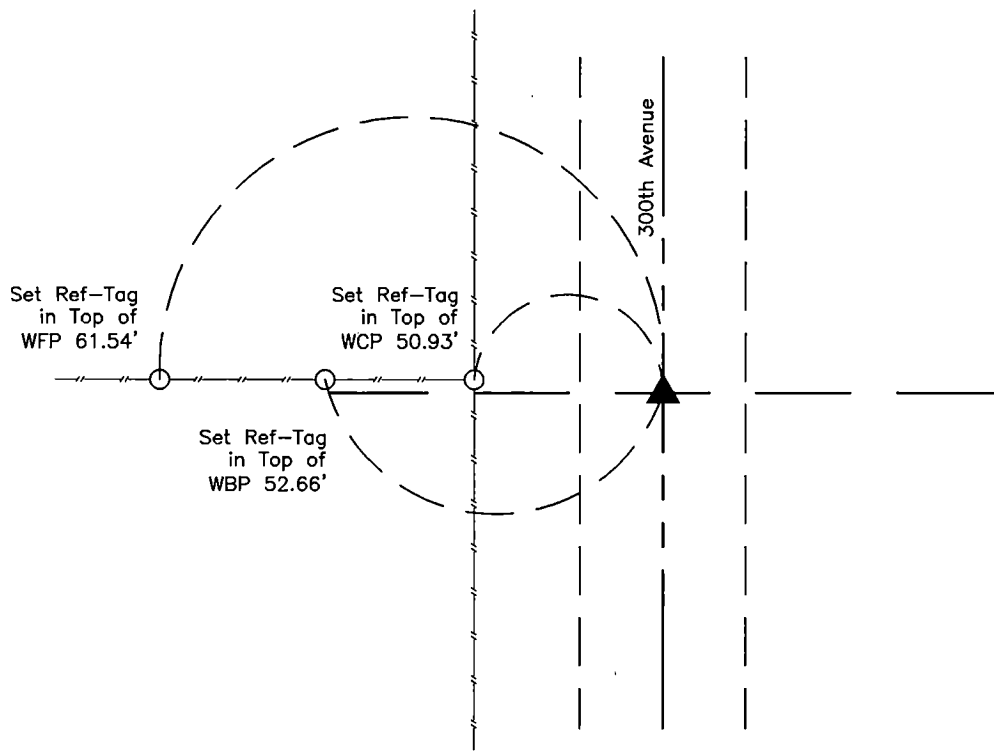

SECTION 17, T 89 N, R 3 W



E 1/4 Corner  
Set Mag Nail w/SSW PLS 17939

TIES ARE TO PLAT Parcel 2023-038  
IN SECTION 17, T 89 N, R 3 W

BURRINGTON GROUP, INC. PROJECT NO. 23-047

I HEREBY CERTIFY THAT THIS LAND SURVEYING DOCUMENT WAS PREPARED AND THE RELATED SURVEY WORK WAS PERFORMED BY ME OR UNDER MY DIRECT PERSONAL SUPERVISION AND THAT I AM A DULY LICENSED PROFESSIONAL LAND SURVEYOR UNDER THE LAWS OF THE STATE OF IOWA.

SEAL COVERS THIS SHEET ONLY

 *6/19/2023*

Randall L. Rattenborg, P.L.S. License #17939 Date  
My license renewal date is December 31, 2023

List Corners to be Indexed:	Section	Township	Range
E 1/4 Corner	17	T 89N	R 3 W

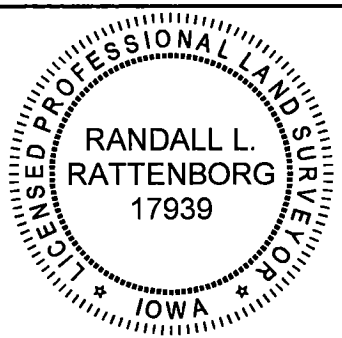

 **BURRINGTON GROUP, INC.**  
Civil Engineering | Land Surveying  
105 W. Main Street Manchester, Iowa 52057