



Book 2023 Page 395

Document 2023 395 Type 06 007 Pages 1  
Date 2/23/2023 Time 10:28:42AM  
Rec Amt \$7.00

Daneen Schindler, RECORDER/REGISTRAR  
DELAWARE COUNTY IOWA

PREPARED BY: RANDALL L. RATTENBORG 105 WEST MAIN STREET MANCHESTER, IA 52057, 563-927-2434

# UNITED STATES PUBLIC LAND SURVEY CORNER CERTIFICATE

Land Survey Monuments situated in Section 6, Township 90 North, Range 3 West of the Fifth Principal Meridian,  
Delaware County, Iowa.

Previously recorded in County Recorder's Office in None  
(book, page, document number, etc.)

NW Corner NE 1/4-NW 1/4; Set 1/2"Ø rebar with orange plastic cap PLS 17939 based on a Plat recorded by Roger Mohn on April 26, 1988 recorded in Book 6, Page 3 on file at the Delaware County Recorder's office in Manchester, Iowa.

N 1/4 Corner; Set 1/2"Ø rebar with orange plastic cap PLS 17939 based on a Plat recorded by Roger Mohn on April 26, 1988 recorded in Book 6, Page 3 on file at the Delaware County Recorder's office in Manchester, Iowa.

NE Corner; Set 1/2"Ø rebar with orange plastic cap PLS 17939 based on a Plat recorded by Roger Mohn on April 26, 1988 recorded in Book 6, Page 3 on file at the Delaware County Recorder's office in Manchester, Iowa.

## PLAN VIEW

(Show a minimum of three reference ties to durable physical objects, relevant monuments and physical conditions that will enable recovery of the corner.)

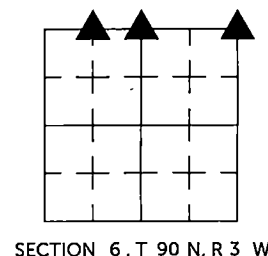
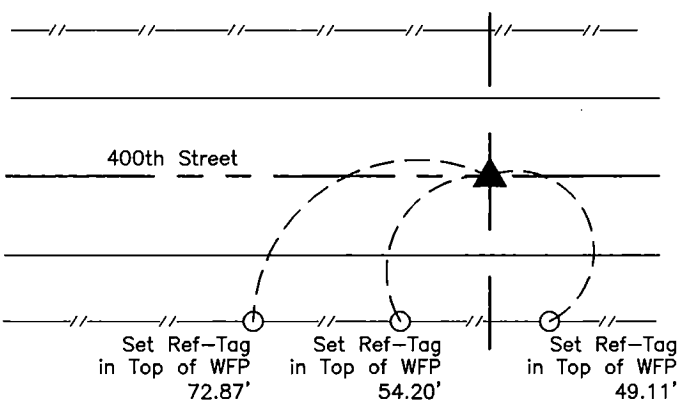

NW Corner NE 1/4-NW 1/4  
Set 1/2"Ø Rebar with Orange Plastic Cap  
PLS 17939

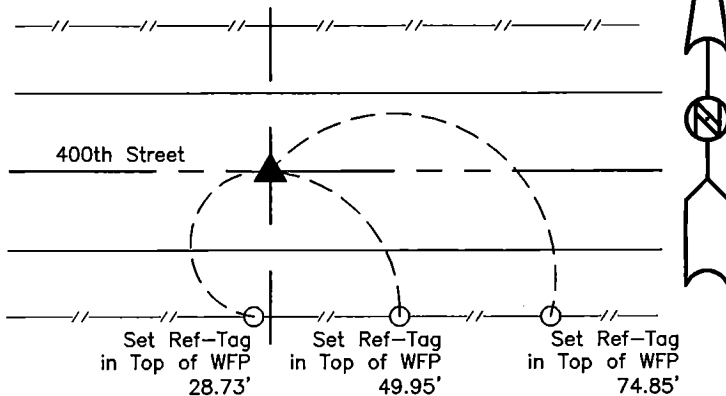

N 1/4 Corner  
Set 1/2"Ø Rebar with Orange Plastic Cap  
PLS 17939

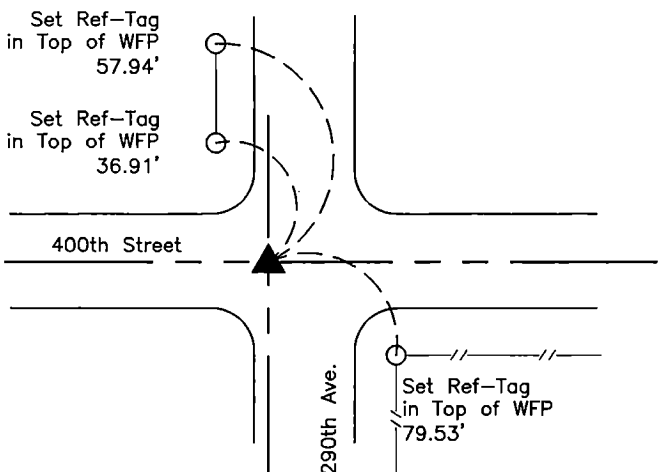

NE Corner  
Set 1/2"Ø Rebar with Orange Plastic Cap  
PLS 17939

TIES ARE TO PLAT P.E. Subdivision  
IN SECTION 6, T 90 N, R 3 W

BURRINGTON GROUP, INC. PROJECT NO.22-187

I HEREBY CERTIFY THAT THIS LAND SURVEYING DOCUMENT WAS PREPARED AND THE RELATED SURVEY WORK WAS PERFORMED BY ME OR UNDER MY DIRECT PERSONAL SUPERVISION AND THAT I AM A DULY LICENSED PROFESSIONAL LAND SURVEYOR UNDER THE LAWS OF THE STATE OF IOWA.

SEAL COVERS THIS SHEET ONLY

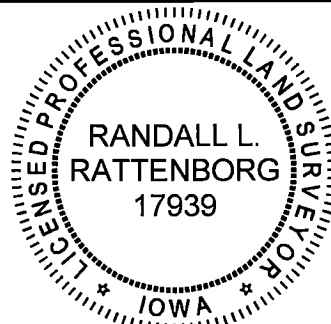

Randall L. Rattenborg, P.L.S. License #17939 Date 2/22/2023  
My license renewal date is December 31, 2023

List Corners to be Indexed: Section Township Range

NE CORNER 6 T 90N R 3 W  
N 1/4 CORNER  
NW CORNER NE-NW

**BURRINGTON GROUP, INC.**  
Civil Engineering | Land Surveying  
105 W. Main Street Manchester, Iowa 52057