

Recorded: 12/1/2022 at 1:09:07.0 PM
County Recording Fee: \$0.00
Iowa E-Filing Fee: \$0.00
Combined Fee: \$0.00
Revenue Tax:
Delaware County, Iowa
Daneen Schindler RECORDER
BK: 2022 PG: 3535

REAL ESTATE TRANSFER - GROUNDWATER HAZARD STATEMENT
TO BE COMPLETED BY TRANSFEROR

TRANSFEROR:

Name James O. and Samantha J. Scott

Address 17080 185th St. Manchester IA 52057
Number and Street or RR City, Town or P.O. State Zip

TRANSFeree:

Name Christopher M. and Abby L. Olson

Address 517 Taylor Dr. Chillicothe IL 61523
Number and Street or RR City, Town or P.O. State Zip

Address of Property Transferred:

17080 185th St. Manchester IA 52057
Number and Street or RR City, Town or P.O. State Zip

Legal Description of Property: (Attach if necessary)

See Attached Exhibit A

1. Wells (check one)

There are no known wells situated on this property.

There is a well or wells situated on this property. The type(s), location(s) and legal status are stated below or set forth on an attached separate sheet, as necessary.

2. Solid Waste Disposal (check one)

There is no known solid waste disposal site on this property.

There is a solid waste disposal site on this property and information related thereto is provided in Attachment #1, attached to this document.

3. Hazardous Wastes (check one)

There is no known hazardous waste on this property.

There is hazardous waste on this property and information related thereto is provided in Attachment #1, attached to this document.

4. Underground Storage Tanks (check one)

There are no known underground storage tanks on this property. (Note exclusions such as small farm and residential motor fuel tanks, most heating oil tanks, cisterns and septic tanks, in instructions.)

There is an underground storage tank on this property. The type(s), size(s) and any known substance(s) contained are listed below or on an attached separate sheet, as necessary.

5. Private Burial Site (check one)

There are no known private burial sites on this property.

There is a private burial site on this property. The location(s) of the site(s) and known identifying information of the decedent(s) is stated below or on an attached separate sheet, as necessary.

6. Private Sewage Disposal System (check one)

All buildings on this property are served by a public or semi-public sewage disposal system.

This transaction does not involve the transfer of any building which has or is required by law to have a sewage disposal system.

There is a building served by private sewage disposal system on this property or a building without any lawful sewage disposal system. A certified inspector's report is attached which documents the condition of the private sewage disposal system and whether any modifications are required to conform to standards adopted by the Department of Natural Resources. A certified inspection report must be accompanied by this form when recording.

There is a building served by private sewage disposal system on this property. Weather or other temporary physical conditions prevent the certified inspection of the private sewage disposal system from being conducted. The buyer has executed a binding acknowledgment with the county board of health to conduct a certified inspection of the private sewage disposal system at the earliest practicable time and to be responsible for any required modifications to the private sewage disposal system as identified by the certified inspection. A copy of the binding acknowledgment is attached to this form.

There is a building served by private sewage disposal system on this property. The buyer has executed a binding acknowledgment with the county board of health to install a new private sewage disposal system on this property within an agreed upon time period. A copy of the binding acknowledgment is provided with this form.

There is a building served by private sewage disposal system on this property. The building to which the sewage disposal system is connected will be demolished without being occupied. The buyer has executed a binding acknowledgment with the county board of health to demolish the building within an agreed upon time period. A copy of the binding acknowledgment is provided with this form. [Exemption #9]

This property is exempt from the private sewage disposal inspection requirements pursuant to the following exemption [Note: for exemption #9 use prior check box]: _____.

The private sewage disposal system has been installed within the past two years pursuant to permit number _____.

Information required by statements checked above should be provided here or on separate sheets attached hereto:

**I HEREBY DECLARE THAT I HAVE REVIEWED THE INSTRUCTIONS FOR THIS FORM
AND THAT THE INFORMATION STATED ABOVE IS TRUE AND CORRECT.**

Signature: _____

(Transferor or Agent)

Telephone No.: _____

(406) 539-2430



TIME OF TRANSFER INSPECTION TOT# 2656 BILL DOWNS CERT # 8880

Site Information

Parcel Description: **James Scott**
Address: **17080 185th St., Manchester, IA 52057** County: **Delaware**

Owner Information

Property is owned by a business: **No**
Business Name:
Owner Name: **James Scott**
Email Address:
Address: **17080 185th St., Manchester, IA 52057**
Phone No:

Additional Contact Information

Name	Email Address	Affiliate Type
Teresa Turnis	teresaturnis@gmail.com	Realtor

Site related information

No Of Bedrooms: 3	Inspection Date: 10/05/2022
Facility Type: Residential	Currently Occupied: Yes
Last Occupied:	System Installation Date: 10/16/2012
Permit issued by County: Yes	Permit Number: 2121
All plumbing fixtures enter septic system: Yes	County contacted for records: Yes
Property Information Comments:	

Primary Treatment

Tank 1

Tank Name: Tank 1	Type: Septic Tank	Tank Size (Gal): 1500
Tank Material: Concrete	Tank Corrosion Type: None	Liquid Level Type: Normal
No. of Compartments: 2	Pump Tank Chamber: No	Licensed Pumper Name: Bill Downs

Date Pumped: **10/5/2022**

Meets Setback to Well: **Yes**

Well Type: **Private**

Distance To Well (Ft.): **100**

Is Accessible: **Yes**

Lid Intact: **Yes**

Risers Intact: **Yes**

Effluent Filter Present: **Yes**

Watertight: **Yes**

Tank/Vault Pumped: **Yes**

Inlet Baffle Present: **Yes**

Outlet Baffle Present: **Yes**

Functioning as Designed: **Yes**

Tank Comments:

General Primary Treatment Comments:

Distribution Type

Distribution Box 1

Label: **Distribution Box 1**

Material Type: **Plastic**

Accessible: **Yes**

Box Opened: **Yes**

Baffle Present: **No**

Speed Levelers Present: **Yes**

Watertight: **Yes**

Functioning As Designed: **Yes**

General Distribution System Comments :

Secondary Treatment

Lateral Field1

Distribution Type: **Distribution Box**

Material Type: **Rock and PVC Pipe**

Trench Width: **36**

Lines: **3**

Total Length of Absorption Line: **300**

System Hydraulic Loaded: **Yes**

Gallons Loaded: **400**

Meets Setback to Well: **Yes**

Well Type: **Private**

Distance To Well (Ft.): **100**

Lateral Lines Probed: **Yes**

Saturation or Ponding Present: **No**

Grass Cover Present: **Yes**

Lateral Lines Equal Length: **Yes**

System Located on Owner Property: **Yes**

Easement Present: **N/A**

Functioning as Designed: **Yes**

Comments:

General Secondary Treatment Comments:

Narrative Report

TOT Inspection Report Overall Narrative Comments: **System in good working condition**

Filter in tank needs cleaned spring & fall



TIME OF TRANSFER INSPECTION TOT# 2656 BILL DOWNS CERT # 8880

Owner Name: **James Scott**

Address: **17080 185th St. , Manchester , IA 52057**

County: **Delaware**

Inspection Date: **10/05/2022**

Submitted Date: **10/12/2022**

This page certifies a Time of Transfer inspection was conducted and submitted for the property listed above in accordance with Subrule 567 IAC 69.2(8).

2121

OASIS PUMP SERVICE
1332 N. Franklin St.
Manchester, IA 52057
319-927-6583

WES
SCHULTE

- From Corner ① of House To Tank = 14 FEET
- From Corner ② of House To D-Box = 34 FEET
- From Tank To D-Box 8 FEET
- From Corner ③ of House To D-Box = 50 FEET

1500 gallon Scales Tank
3-100' lines Rack + Pipe
1" Clean

Installed
10-16-12

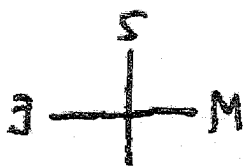
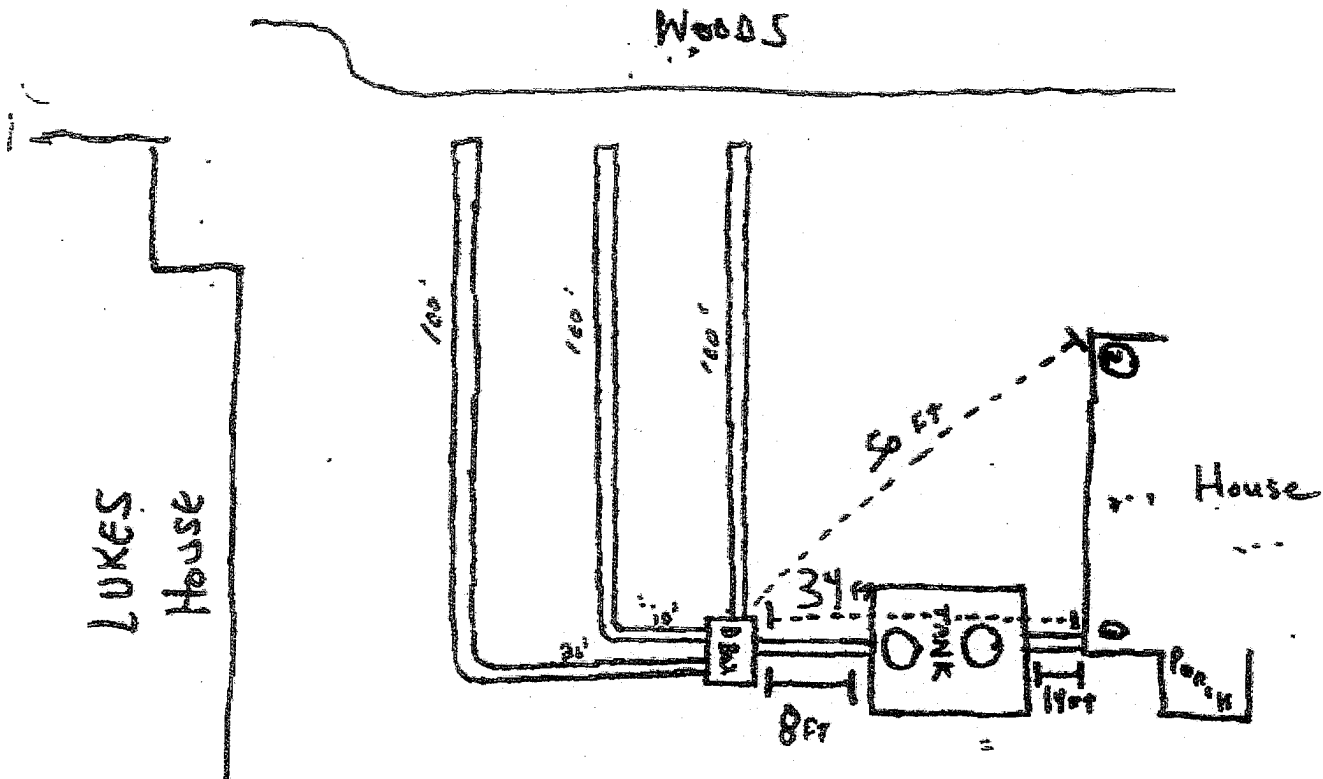

185th St.

Suburban
Highway
2 miles

Wes + Jamie
Schulte -
(Fawn Trail)

NE Corner of
House -

- Geo line ① 30' 6"
- ② 49' 6"
- ③ 60' 5"
- ④ 81' 5"

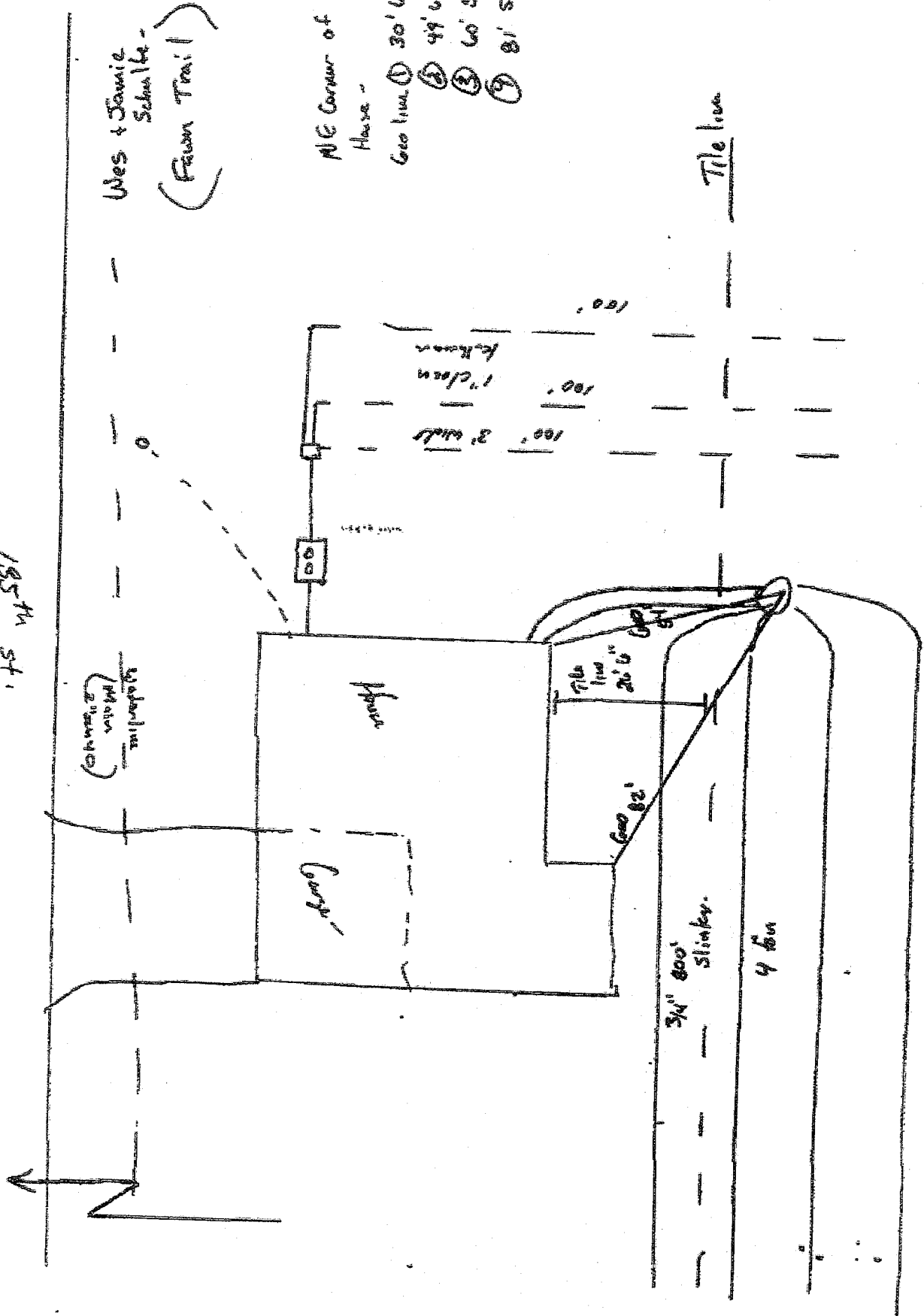

100' 3" wide
1" clear
kitchen

3/4" 800' Sinker

4 feet

Tile floor

DELAWARE COUNTY
BOARD OF SUPERVISORS

190 17 07 00 00
42.51911 - 91,46935

(Print or Type)

Permit No. 2121

APPLICATION FOR PERMIT TO INSTALL PRIVATE SEWAGE DISPOSAL SYSTEM

ADDRESS: 17080-185th St

LOCATION:

Section 17 Township Delaware
T-89-N R.S-60

Owner: Mrs. Schultze

Tenant:

Plumber: O.P.S.

Lot Size: 1.5

Type Commercial:

Residential: (No. Bedrooms) 3

Furnace: 2

Washers: 2

Bath Tubs: 2

Showers: 3

Sinks: 4

Automatic Laundry: 1

Sump Pump:

Septic Tank made by: Sewer

Garbage Grinder:

Construction Material: Coburk Gallons Cap. 180

Percolation Test: 1 _____ 2 _____

3 _____ 4 _____

Made by:

Absorption Field: Total length of laterals

300

No. of lateral lines

3

This system is new Existing _____

3' wide - Oct 10 1910

I certify that the above information is correct and that all prepared work will be completed in accordance with the Delaware County Regulations.

Date Approved

10-16-12

By: David Green
INSPECTOR

SEAL

[Signature]
APPLICANT'S SIGNATURE