

Recorded: 5/23/2022 at 9:48:07.0 AM
County Recording Fee: \$7.00
Iowa E-Filing Fee: \$3.13
Combined Fee: \$10.13
Revenue Tax:
Delaware County, Iowa
Daneen Schindler RECORDER
BK: 2022 PG: 1635

PREPARED BY/RETURN TO: FEHR GRAHAM, 221 E. MAIN ST., SUITE 301, MANCHESTER, IA 52057 - PH: 563-927-2060

UNITED STATES PUBLIC LAND SURVEY CORNER CERTIFICATE
DELAWARE COUNTY, IOWA
SECTION 32-T88N-R3W

W1/4 CORNER OF
SEC. 32-88-3

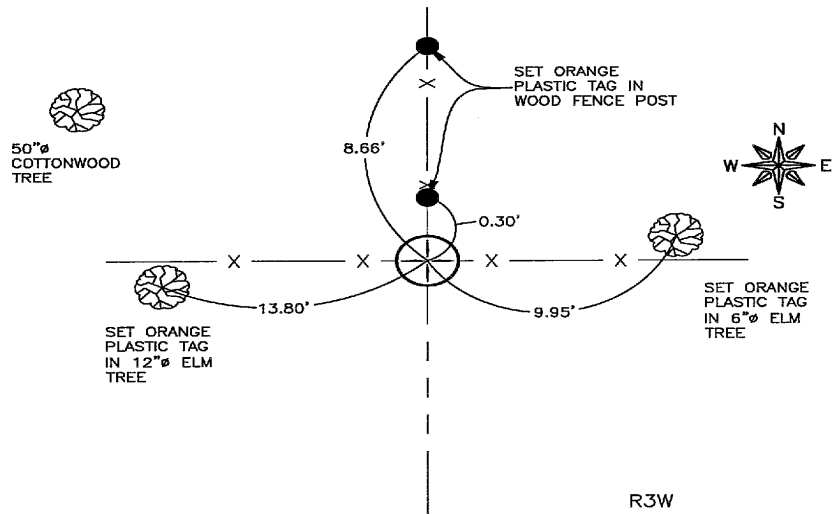

PREVIOUSLY RECORDED:
NO PREVIOUS CERTIFICATE ON FILE

PURPOSE OF CERTIFICATE:
SET MONUMENT AT INTERSECTION OF FENCE LINES AND USED A
DISTANCE FROM CENTER OF SECTION TO THE NORTHEAST CORNER OF
THE NW1/4-SW1/4 TO CHECK LOCATION FROM A PLAT RECORDED IN
BOOK 2009, PAGE 3363 IN DELAWARE COUNTY RECORDER'S OFFICE,
MANCHESTER, IOWA AND SECTION CORNER CERTIFICATES FROM PLAT.

MONUMENT DESCRIPTION AND ESTABLISHMENT:
SET 1/2"Ø REBAR W/2"Ø ALUMINUM CAP #24627

CORNERS TO BE INDEXED

CORNER	SECTION	TOWNSHIP	RANGE
(1) W1/4	32	88N	3W



I hereby certify that this land surveying document
was prepared and the related survey work was
performed by me or under my direct personal
supervision and that I am a duly licensed Land
Surveyor under the laws of the State of Iowa.

Adam J. Recker
Adam J. Recker, P.L.S.
License Number: 24627

My license renewal date is December 31, 2023.
Sheets covered by this seal: THIS SHEET ONLY

5-19-2022
Date

FEHR GRAHAM
ENGINEERING & ENVIRONMENTAL
© 2022 FEHR GRAHAM

ILLINOIS
IOWA
WISCONSIN

G:\C3D\22\22-546 Gibbs\22-546 SCC M.dwg

JOB NUMBER:
22-546

SHEET NUMBER:
1 of 1