



Book 2022 Page 1584

Document 2022 1584 Type 03 006 Pages 2

Date 5/17/2022 Time 11:01:25AM

Rec Amt \$12.00

Daneen Schindler, RECORDER/REGISTRAR
DELAWARE COUNTY IOWA

Recorder's Cover Sheet

WIND FARM EASEMENT (Supplemental Exhibit)

Preparer Information:

Felix Friedman, 1863 Earlham Rd, Winterset, IA 50273

Taxpayer Information:

N/A

Return Address

Independence Wind Energy LLC, c/o BHE Renewables, LLC, Attn: Jason Romey, 666 Grand Avenue, Suite 500, Des Moines, IA 50309 Phone (515) 242-3988

Grantors:

Alan J. Nachtman and Marcia R. Nachtman, husband and wife, as contract purchasers, subject to the rights of the contract seller Caroline A. Nachtman as Trustee of the Caroline A. Nachtman Revocable Trust Agreement dated May 17, 2017

Grantees:

Independence Wind Energy LLC

Legal Description: See Easement descriptions on attached As-Built drawings (Exhibit C)

Document or instrument number if applicable:

The attached As-Built drawing is the **Exhibit C** referred to in the Memorandum of Wind Farm Easement Agreement recorded in **Book 2020 at Page 3818** of the Delaware County Records, and replaces **Exhibit B** attached to that document.

Property #191

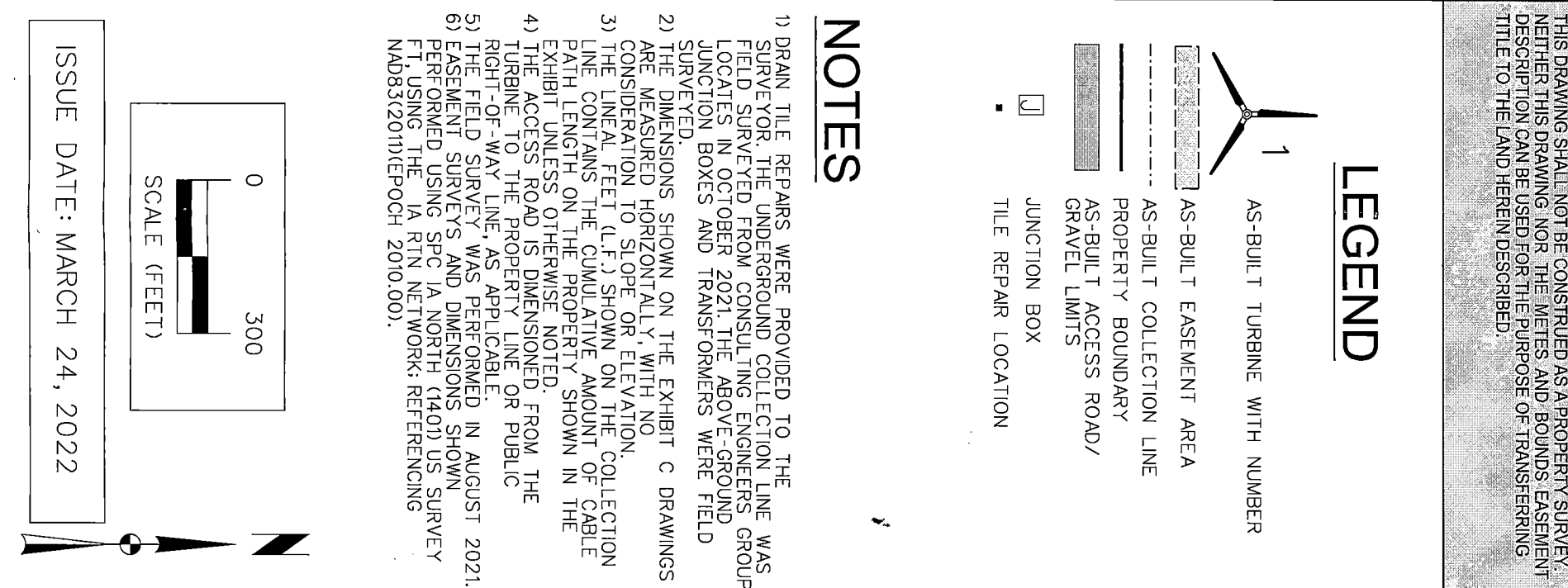

LEGEND

A vertical scale bar with a horizontal line at the top labeled '0' and another horizontal line at the bottom labeled '300'. The text 'SCALE (FEET)' is written vertically to the left of the bar. The bar itself is divided into three equal segments by two horizontal lines. The top segment is white, the middle segment is black, and the bottom segment is white.

INDEPENDENCE WIND ENERGY PROJECT DELAWARE CO., IOWA
EXHIBIT C - PARCEL #191 ALAN J. AND MARCIA R. NACHTMAN, ETAL

SNYDER & ASSOCIATES, INC. 2727 S.W. SNYDER BLVD.
ANKENY, IOWA 50023
515-964-2020 | www.snyder-associates.com

MARK		REVISION		DATE	BY
Engineer:		Checked By: EJM		Scale: 1"= 300'	
Technician: SLG		Date: 01-21-2022		Field Bk:	Pg:
Project No: 120.1064.01A			Sheet 1 of 1		